

LIMITED RIGHTS IN DATA
THIS DOCUMENT CONTAINS PROPRIETARY AND TRADE
SECRET DATA OF THE KABA MAS LLC.
IT MAY NOT BE USED, REPRODUCED OR RELEASED IN
WHOLE OR IN PART FOR ANY PURPOSE OTHER THAN
THAT AUTHORIZED BY THE KABA MAS LLC.
AUTHORIZATION MUST BE IN WRITING.

SAME AS AX

REV.	ECN	DESCRIPTION	REV. BY	CHKD. BY	DATE
A	1680	RELEASE NEW CHANGE KEY, UNIVERSAL SHORT REPLACES BOTH 1307 & 1315	KCS	BTC	10JUN13

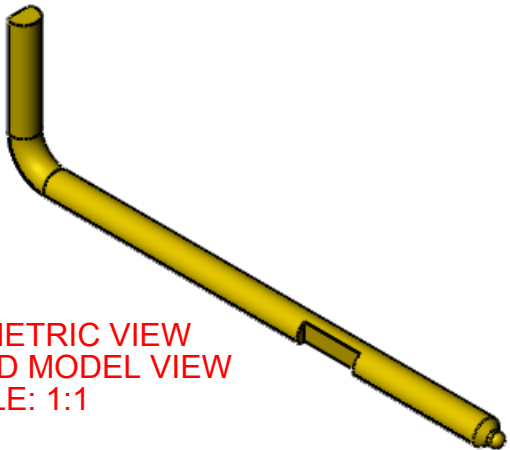
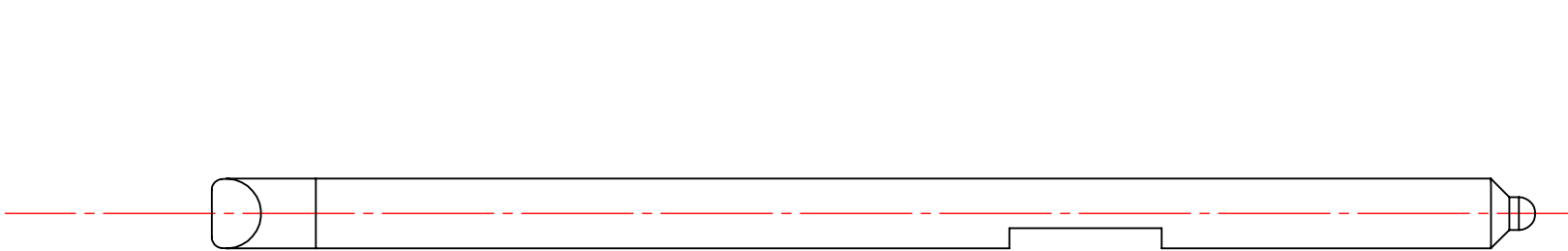

ISOMETRIC VIEW
SOLID MODEL VIEW
SCALE: 1:1

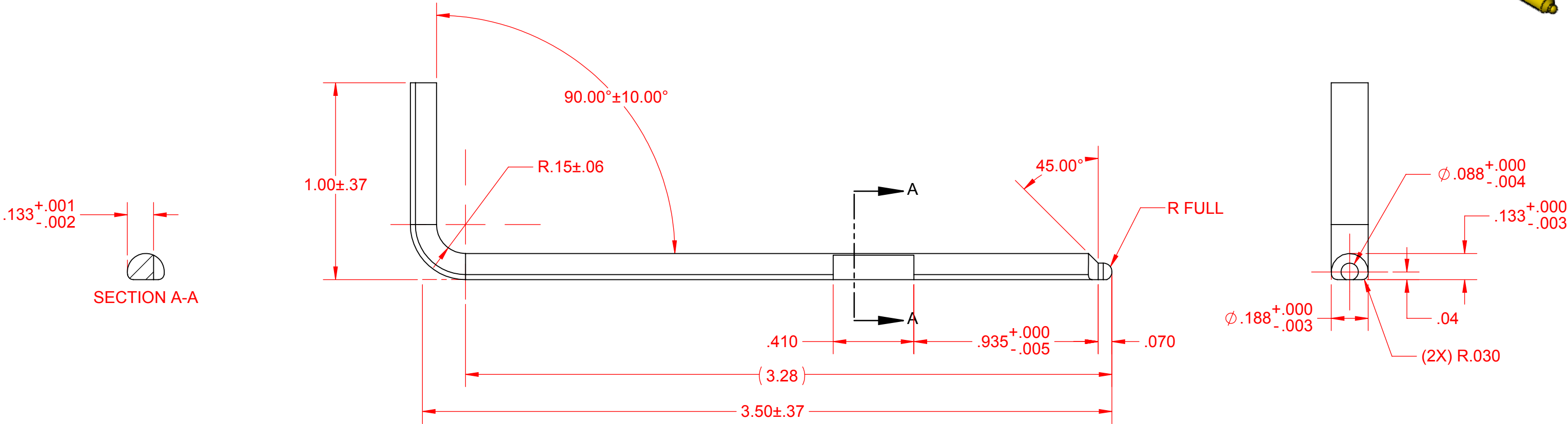

- NOTES:
- MATERIAL TO BE 12L14 LOW CARBON DRAWN STEEL
 - FINISH: BLACK OXIDE

REF. ASME Y14.5-2009



THIRD ANGLE
PROJECTION

DO NOT SCALE PRINT
UNLESS OTHERWISE
SPECIFIED (U.O.S.):
DIMENSIONS: INCHES
TOLERANCES:
.XX \pm .01
.XXX \pm .005
FRACTIONS \pm 1/64
ANGLES \pm 1.0°
DRAFT 1° MAX

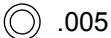

.005

MACHINED SURFACE



749 W. SHORT ST.
LEXINGTON, KY 40508
PHONE 859-253-4744

TITLE	KEY, CHANGE, SHORT, 3 & 4 WH UNIV, RoHS		BY	DATE
		DR.	KCS	06JUN13
MATERIAL	SEE NOTE 1	CK.	BTC	06JUN13
		APP.	BTC	06JUN13

SCALE	2:1	SHEET	1 OF 1	SIZE	B	PT.NO.	705160	REV.	A
-------	-----	-------	--------	------	---	--------	--------	------	---

MUST BE IN COMPLIANCE WITH THE LATEST LEVEL EU DIRECTIVE 2002/95/EC (RoHS).