

# Chemical Products for Construction



**Sealants, Adhesives**

Page 2/100



**Wood-Float, Glue**

Page 2/125



**PU Foams, Stairs Glue**

Page 2/137



**Window Fitting**

Page 2/161



**Quick Cement**

Page 2/198



**Boiler, Burner Cleaner**

Page 2/202



**Cold Glue**

Page 2/208



**Wood Repair**

Page 2/209

## Multi-Purpose Tray, Plastic

- Suitable for oil, petrol, different acids and chemicals
- With medium socket for small parts cleaning
- Pointed grommet for safe decanting

### Technical Data

<b>Volume:</b>	9 l
<b>Weight:</b>	1.0 kg
<b>Measurements HxLxW</b>	15 x 32 x 32 cm
<b>Material:</b>	polyethylene

Article No.	Article Description	QTY
5421 9	MULTI-PURPOSE TRAY,PLASTIC 9L	1



# Round Cord Seal

- To backfill sealing and expansion joints for e.g. for window connecting joints, sanitary joints etc.
- Round cords are used to limit joint depths and to avoid a three-flank adhesion
- Due to its neutral characteristics ideal as a primer for priming surfaces
- Fine-porous, closed-cell polyethylene-foam
  - No absorption and binding of water
- For indoor and outdoor use
- Resistant against assembly foams and other sealant on silicone, polysulfide, polyurethane or polyacrylate basis
- Complies with DIN 18540
  - Foerch quality with highest application guarantee for any building sealing jobs
- Designed for 6 mm to 30 mm diameter in endless-dispenser-box
  - Ideal extraction
  - Optimised storing
- 40 mm diameter in 2.0 rods

### Processing advice:

- To apply into joint use blunt tool in order to prevent damage to the surface

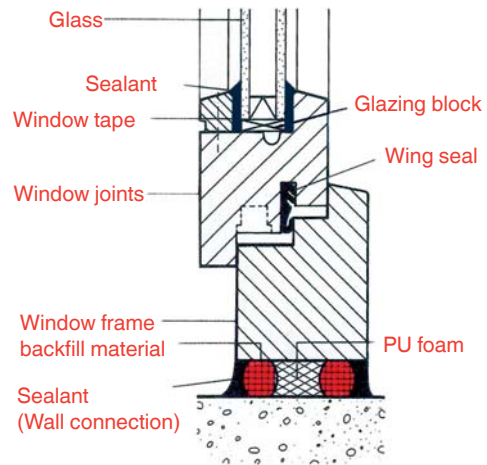

### Technical Data

<b>Material:</b>	closed cell polyethylene
<b>Colour:</b>	grey
<b>Volume weight:</b>	33 kg/cm <sup>3</sup>
<b>Temperature resistant:</b>	-40°C to +60°C
<b>Water absorption:</b>	none
<b>Fire behaviour:</b>	flammable

Article No.	Article Description	QTY
8803 6	MTR.ROUNDCORDSEAL 6MM	H 500
8803 8	MTR.ROUNDCORDSEAL 8MM	H 500
8803 10	MTR.ROUNDCORDSEAL 10MM	H 500
8803 15	MTR.ROUNDCORDSEAL 15MM	H 500
8803 20	MTR.ROUNDCORDSEAL 20MM	f 250
8803 30	MTR.ROUNDCORDSEAL 30MM	g 125
8803 40	MTR.ROUNDCORDSEAL 40MM	135

# Round Cord Seal PUR

- Fine-porous, open-cell foam **PUR** to backfill expansion joints such as window connection joints, sanitary joints etc.
- PUR foam material is easier to process as they are more compressible
- PUR - round cords are used to limit the joint depth in order to avoid three-flank adhesion
- Resistant against assembly foams and other sealant on silicone, polysulfide, polyurethane or polyacrylate
- Easy to process
- Do not use if **DIN 18540** is required
- Only for **indoor use**
- Design: all diameters in 1.0 rods

### Processing advice:

- To apply into joint use blunt tool in order to prevent damage to the surface



### Technical Data

<b>Material:</b>	open-cell PUR foam material
<b>Colour:</b>	grey
<b>Volume weight:</b>	18+-2 kg/m <sup>3</sup>

Article No.	Article Description	QTY
8803 1 10	MTR.ROUND CORD PUR 10 MM	1500
8803 1 15	MTR.ROUND CORD PUR 15 MM	1000
8803 1 20	MTR.ROUND CORD PUR 20 MM	500
8803 1 30	MTR.ROUND CORD PUR 30 MM	250
8803 1 40	MTR.ROUND CORD PUR 40 MM	150
8803 1 50	MTR.ROUND CORD PUR 50 MM	100

# Window Tape

- For glazing of windows and doors
- Closed PE-cell structure
- Resistant to weather and chemicals
- Works as movement cushioning during strong winds and other mechanical stresses
- High elasticity
- Excellent thermic insulation values
- Without PE-peel-off film
- Waste disposal of PE-foil not necessary as with other sealant tapes
- Consistent adhesion, since the sealant tapes cannot unroll and therefore cannot get dirty
- Prevents three-point-adhesion
- Fills glazing rebate
- Low sealant usage



Article No.	Article Description	QTY
8802 2 6	MTR<200>WIND.TAPE GREY 2 X 6	200
8802 2 6 1	MTR<200>WIND.TAPE WHITE 2 X 6	200
8802 2 9	MTR<200>WIND.TAPE GREY 2X9	200
8802 2 9 1	MTR<200>WIND.TAPE WHITE 2 X 9	200
8802 2 12	MTR<200>WIND.TAPE GREY 2 X12	W 1000
8802 2 12 1	MTR<200>WIND.TAPE WHITE 2 X12	200
8802 2 15	MTR<200>WIND.TAPE GREY 2 X15	200
8802 2 20	MTR<200>WIND.TAPE GREY 2 X20	200
8802 3 6	MTR<200>WIND.TAPE GREY 3 X 6	200
8802 3 6 1	MTR<200>WIND.TAPE WHITE 3 X 6	200
8802 3 9	MTR<200>WIND.TAPE GREY 3 X 9	200
8802 3 9 1	MTR<200>WIND.TAPE WHITE 3 X 9	200
8802 3 12	MTR<200>SEALING TAPE GREY 3X12	200
8802 3 12 1	MTR<200>WIND.TAPE WHITE 3 X12	200
8802 3 15	MTR<200>SEALING TAPE GREY 3X15	200
8802 3 15 1	MTR<200>WIND.TAPE WHITE 3 X15	200
8802 3 20	MTR<200>WIND.TAPE GREY 3 X20	200
8802 3 40	MTR<300>WIND.TAPE GREY 3 X40	300
8802 4 9	MTR<200>SEALING TAPE GREY 4X9	200
8802 4 9 1	MTR<200>WIND.TAPE WHITE 4 X 9	200
8802 4 12	MTR<200>SEALING TAPE GREY 4X12	200
8802 4 12 1	MTR<200>WIND.TAPE WHITE 4 X12	200
8802 4 15	MTR<200>SEALING TAPE GREY 4X15	200
8802 4 20	MTR<200>WIND.TAPE GREY 4 X20	200
8802 4 40	MTR<300>WIND.TAPE GREY 4 X40	300
8802 5 9	MTR<100>WIND.TAPE GREY 5 X 9	100
8802 5 9 1	MTR<100>WIND.TAPE WHITE 5 X 9	100
8802 5 15	MTR<100>WIND.TAPE GREY 5 X15	100
8802 5 20	MTR<100>WIND.TAPE GREY 5 X20	H 300
8802 6 9	MTR<100>WIND.TAPE GREY 6 X 9	100
8802 6 9 1	MTR<100>WIND.TAPE WHITE 6 X 9	100
8802 6 12	MTR<100>WIND.TAPE GREY 6 X12	100
8802 6 15	MTR<100>WIND.TAPE GREY 6 X15	100
8802 6 20	MTR<100>WIND.TAPE GREY 6 X20	100

(Thickness x tape width in mm)

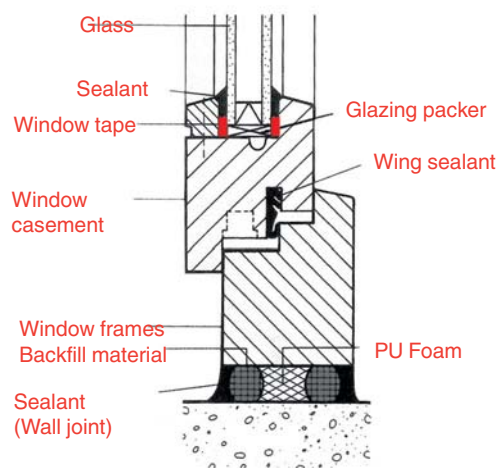

# Window Tape I-flex/A-flex

- For fast and secure sealing of window connection joints
- Choose between steam non-permeable (interior) or steam permeable (exterior) depending on intended use
- Can be plastered and painted
- With flexible fittings, allows to absorb the building's movement precisely, which prevents cracks on the plaster
- High adhesion of the self-adhesive strip on any kind of window frames
- Butyl adhesive-strip fixes the tape durably and reliably to the brick-work
- Complies with RAL-requirements for window fitting
- Test certificate by the Institute for Material Testing Hannover regarding steam and air permeability

## Application:

- Adhesive surfaces have to be dry, oil, grease- and dustfree. Primer is recommended (item number >6880 8 500) for heavy porous surfaces (e.g. concrete, porous concrete, solid plaster, untreated steel, untreated wood, rough glass)



## Two-way butyl adhesive interior (I-Flex):

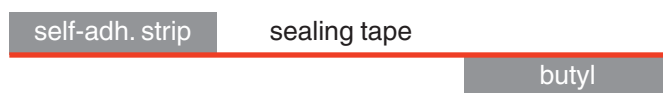

## One-way butyl adhesive exterior (A-Flex):

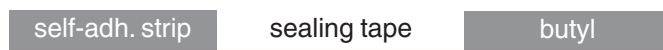

## Two-way butyle adhesive exterior (A-Flex W):

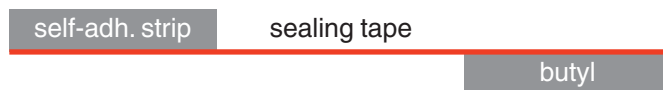

Article No.	Article Description	QTY
8804 3 50	MTR<20>WIND.TAPE.I-FLEX 50	120
8804 3 70	MTR<20>WIND.TAPE.I-FLEX 70	100
8804 3 100	MTR<20>WIND.TAPE.I-FLEX 100	60
8804 3 150	MTR<20>WIND.TAPE.I-FLEX 150	40
8804 6 50	MTR<20>WIND.TAPE.A-FLEX 50	120
8804 6 70	MTR<20>WIND.TAPE.A-FLEX 70	100
8804 6 100	MTR<20>WIND.TAPE.A-FLEX 100	60
8804 6 150	MTR<20>WIND.TAPE.A-FLEX 150	40
8804 7 50	MTR<20>WIND.TAPE.A-FLEX W 50	120
8804 7 70	MTR<20>WIND.TAPE.A-FLEX W 70	100
8804 7 100	MTR<20>WIND.TAPE.A-FLEX W 100	60
8804 7 150	MTR<20>WIND.TAPE.A-FLEX W 150	40

# Window Tape I-Basic/A-Basic

- For fast and secure sealing of window connection joints for interior and exterior use
- Choose between steam non-permeable (interior) or steam permeable (exterior) depending on intended use
- The fleece, which can be plastered and painted, is adhered to the surface (brickwork) with **Window Sealant** (item number 6880 8 310, item number 6880 8 600, large unevennesses can be hence evened out
- With flexible expansion area, allows to absorb the building's movement precisely, which prevents cracks on the plaster
- High adhesion of the self-adhesive strip on any kind of window frames
- Complies with RAL-requirements for window fitting
- Test certificate by the Institute for Material Testing Construction Hannover

## Application:

- Adhesive surfaces have to be dry, oil, grease- and dustfree. Primer is recommended (item number 6880 8 500) for heavy porous surfaces (e.g. concrete, porous concrete, solid plaster, untreated steel, untreated wood, rough glass)
- Remove protective film from the self-adhesive strip and stick the window tape on the window frame/back
- Make a loop on each corner, press the adhesive strips of the loops together
- Adjust window element, fix it and foam insulating material (1K-PU-foam)
- Apply sealing paste Foerch as a seam without any gaps on the surface (brickwork) and press the tape on



## SK-adhesive with window sealant for interior / exterior:

self-adh. strip

sealing tape

Article No.	Article Description	QTY
8804 8 70	MTR<40>WIND.TAPE.I-BASIC 70	200
8804 8 100	MTR<40>WIND.TAPE.I-BASIC 100	120
8804 8 150	MTR<40>WIND.TAPE.I-BASIC 150	80
8804 9 70	MTR<40>WIND.TAPE.A-BASIC 70	200
8804 9 100	MTR<40>WIND.TAPE.A-BASIC 100	120
8804 9 150	MTR<40>WIND.TAPE.A-BASIC 150	80



# Window Tape Vario



- Humid, variable sealing tape for connecting windows and doors
- Water vapour permeability tested by MFPA Leipzig
- Suitable for outside and inside
- Regulates the humidity in the joint depending on the season
- Guarantees long-lasting sealing according to RAL
- Stretchable in transverse direction
- Can be plastered and painted over

## Application:

- Surfaces to be treated must be dry, free of oil, grease and dust. Primer (Art. No. 6880 8 500) is recommended for heavy porous substrates (e.g. concrete, aerated concrete, solid plaster, untreated steel, untreated wood, rough glass).
- Remove protective film from self-adhesive strip and stick the window tape on the window frame/back
- Make a loop on each corner and press the adhesive strips of the loop together
- Adjust window element, fix it and foam insulating material (1K-PU-Foam)
- Apply the Försch sealing paste as a seam without any gaps on the surface (brickwork) and press the tape on



self-adhesive strip      sealing tape

Article No.	Article Description	QTY
8804 20 70	MTR<40>WINDOW TAPE VARIO 70	200
8804 20 100	MTR<40>WINDOW TAPE VARIO 100	120
8804 20 150	MTR<40>WINDOW TAPE VARIO 150	80

## Technical Data

Colour	brown-beige
Sd-value	0.4 - 15 m Sd
Processing temperature	from +5°C to +50°C
Temperature resistance	from -30°C to +80°C
Building material class	B2
Weather resistance	3 months
Driving rain resistance	≥600 Pa.

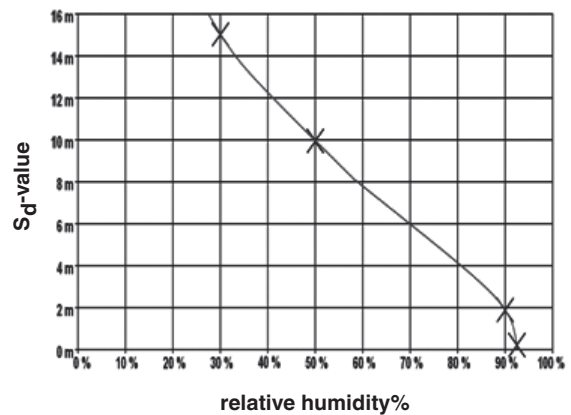

# Window Tape Vario Plus

- Humid, variable sealing tape for connecting windows and doors
- Water vapour permeability tested by MFPA Leipzig
- Suitable for outside and inside
- Regulates the humidity in the joint depending on the season
- Guarantees long-lasting sealing according to RAL
- Stretchable in transverse direction
- Can be plastered and painted over with integrated **butyl sealing strip**

## Application:

- Surface to be treated must be dry, free of oil, grease and dust. Primer (Art. No. 6880 8 500) is recommended for heavy porous substrates (e.g. concrete, aerated concrete, solid plaster, untreated steel, untreated wood, rough glass).
- Remove protective film from self-adhesive strip and stick the window tape on the window frame/back
- Make a loop on each corner and press the adhesive strips of the loop together
- Adjust window element, fix it and foam insulating material (1K-PU-Foam)
- Press the butyl strip to the reveal airtight



self-adhesive strip

butyl

Article No.	Article Description	QTY
8804 21 70	MTR<20>WIND.TAPE VARIO PLUS 70	100
8804 21 100	MTR<20>WIND.TAPE VARIO PLUS100	60
8804 21 150	MTR<20>WIND.TAPE VARIO PLUS150	40

## Technical Data

Colour	brown-beige
Sd-value	0.4 - 15 m Sd
Processing temperature	from +5°C to +50°C
Temperature resistance	from -30°C to +80°C
Building material class	B2
Weather resistance	3 months
Driving rain resistance	≥600 Pa.

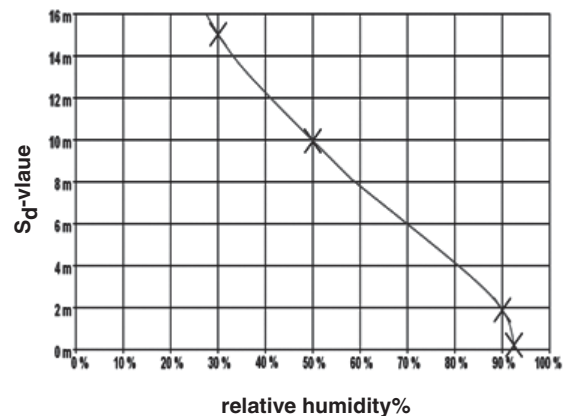

# Duo Fleece I / Mono Fleece I

- For fast and secure non-permeable sealing of interior window connection joints
- Consists of a self-adhesive elastic **all-over butyl rubber compound** with strong adhesion which is lined on one side with a plastic fleece
- For the version Duo Fleece I a self-adhesive strip was applied in addition which holds without problems on any kind of window frames
- Both types can be plastered and painted due to their fleece lining
- Complies with RAL requirements for window fitting
- Building material class B12 according to DIN 4102-1
- Test certificate from the Institute for Material Testing regarding the water steam permeability

### Application:

- Primer is recommended (item number 8804 1 or 8804 1 1) for heavy porous surfaces (e.g. concrete, porous concrete, solid plaster, untreated steel, untreated wood, rough glass), adhesive areas have to be dry and free from oil, grease and dust



### Two-way all-over butyl adhesive interior (Duo Fleece):

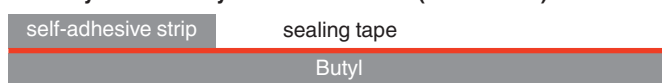

### One-way all-over butyl adhesive interior (Mono Fleece):



Article No.	Article Description	QTY
8804 75	MTR<15>WIN.TAPE.DUO.FLE. I 75	45
8804 100	MTR<15>WIN.TAPE.DUO.FLE. I 100	45
8804 10 75	MTR<15>WIN.TAP.MONO.FLE. I 75	45
8804 10 100	MTR<15>WIN.TAP.MONO.FLE. I 100	45



**Picture 1:**  
Press adhesive strip of fleece-lined side carefully onto the window frame.

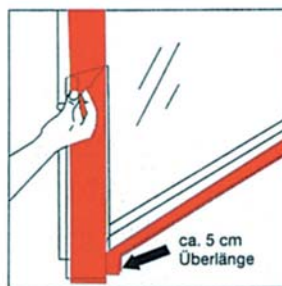

**Picture 2:**  
Apply to all sides of the window which need to be sealed. Then adjust the window and fit it. Fill the hollow between window and wall with insulation material e.g. 1K-PU-Foam.



**Picture 3:**  
Remove protective foil on the butyl side, adhere the tape to the surface and press on carefully.



**Picture 4:**  
The fleece-lined side can be plastered or painted with dispersion paint.

# Butyl and Bitumen Primer for RAL Sealing Tapes

- Adhesive surface bond for butyl and bitumen
- Recommended for very porous and priming surfaces such as concrete nature, porous concrete, solid plaster, untreated wood, untreated steel and rough glass
- Ventilation time approx. 30 - 60 minutes
- Consumption approx. 300 ml/m<sup>2</sup>, depending on the surface condition
- Processing temperature: +5°C to +30°C

Article No.	Article Description	QTY
8804 1	BUTYL.PRIMER TRANS.1L CAN	1 d
8804 1 1	BUTYL.PRIMER BLACK 1L CAN	1 d



# Window Tape Alu I

- For the interior window connection joint
- Ideal for renovation and refurbishing
- Tape hardly adds to thickness, hence covering with flat rail possible
- Non-permeable
- Strong adhesion of the butyl and self-adhesive strip
- Complies with RAL-requirements for window fitting
- Building material class B2 according to DIN 4102
- Test certificate by the MPA NRW regarding water permeability according to DIN 52615

## Application:

- Remove protective foil from the butyl strip and adhere to the surface (jamb) in such a way that it lies behind the window level
- Fit heat insulation in the window connection joint (e.g. 1K-PU-foam)
- Remove the protective foil of the adhesive strip and fit the self-adhesive side with a minimum of 10 mm overlay to the window frame
- Primer is recommended (item number 8804 1 or 8804 1 1) for heavy porous surfaces (e.g. concrete, porous concrete etc), adhesive areas have to be dry and free from oil, grease and dust



Article No.	Article Description	QTY
8804 1 50	MTR<25>WIND.TAP.ALU I 50	175
8804 1 75	MTR<25>WIND.TAP.ALU I 75	125
8804 1 100	MTR<25>WIND.TAP.ALU I 100	75

## Two-way butyl adhesive interior:

self-adh. strip

sealing tape

butyl

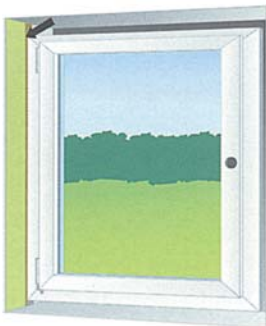

**Picture 1:**  
Adhere the butyl stripe of the window sealant tape to the jamb.



**Picture 2:**  
Adjust window joint and foam insulating material (1K-PU-foam)



**Picture 3:**  
Fold back the window sealant tape and adhere the self-adhesive strip to the window frame.



**Picture 4:**  
The connecting joint can be covered visually with a flat rail.



# Joint Tape 3 in 1

- Multi-functional tape for sealing connection joints in one operation
  - Exterior: driving rain proof
  - Middle: heat and sound insulation
  - Interior: air-tight
- Can be installed in any weather conditions
- Time and cost saving
- No edge tearing when components move
- Complies with EnEV and DIN 18355 for the German Construction Contract Procedures for carpentry
- General approval for construction
- Type-tested by ift-Rosenheim MO-01/:2007-1

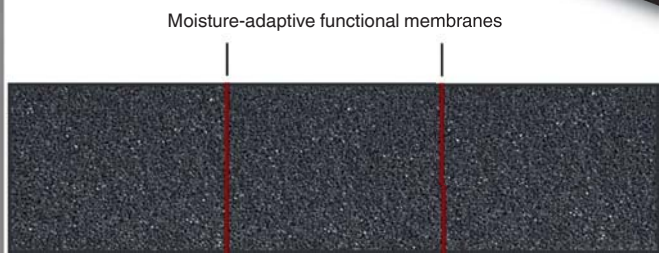

## Technical Data

Art. No.	Tape width in mm	Wind. constr. depth in mm	Joint width in mm
8806 56 4 9	56	60	4-9
8806 56 6 15	56	60	6-15
8806 56 10 20	56	60	10-20
8806 64 4 9	64	70	4-9
8806 64 6 15	64	70	6-15
8806 64 10 20	64	70	10-20
8806 64 15 30	64	70	15-30
8806 74 4 9	74	80	4-9
8806 74 6 15	74	80	6-15
8806 74 10 20	74	80	10-20
8806 74 15 30	74	80	15-30

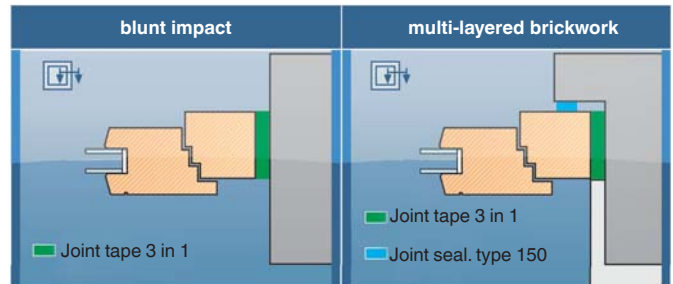

Article No.	Article Description	QTY
8806 56 4 9	RO (9.4)JOINTTAPE 3IN1 56/4- 9	5
8806 56 6 15	RO (7.0)JOINTTAPE3IN1 56/6 -15	5
8806 56 10 20	RO (4.7)JOINTTAPE3IN1 56/10 20	5
8806 64 4 9	RO (9.4)JOINTTAPE 3IN1 64/4- 9	4
8806 64 6 15	RO (7.0)JOINTTAPE3IN1 64/6 -15	4
8806 64 10 20	RO(4.7)JOINTTAPE3IN1 64/10 -20	4
8806 64 15 30	RO(4.7)JOINTTAPE3IN1 64/15 -30	4
8806 74 4 9	RO (9.4)JOINTTAPE 3IN1 74/4- 9	4
8806 74 6 15	RO (7.0)JOINTTAPE3IN1 74/6 -15	4
8806 74 10 20	RO(4.7)JOINTTAPE3IN1 74/10 -20	4
8806 74 15 30	RO(4.7)JOINTTAPE3IN1 74/15 -30	4

Colour:		black, with functional membrane
Wear group:	DIN 18542:2009	BG-2/BG-R
Fire behaviour:	DIN 4102-1	B2; P-NDS04-726, MPA*
Joint permeability coefficient:	DIN EN 12114	$a_n \leq 0.1$ ; 083539.1-Sz, MPA*
Driving rain tightness:	DIN EN 1027	$\geq 1050$ Pa; 083539.1-Sz, MPA*
Temperature resistance:		-30° to +80°C
Thermal conductivity:	DIN EN 12667	$\lambda \leq 0.0428$ W/m*K
Joint sound insulation $R_{ST,W}$ :	ift SC-01/2:2002-09	unplastered: 57 dB
Thermal-hygro component simulation:		"... over-hygrical water contens up to condensation inside the component are not expected." 2008772-4, BBS*
Compatibility with standard material:		yes
Processing temperature:		+5° to +30°C. Pre-cool the tape at +20°C, pre-heat at low temperatures, if necessary.
Shelf life:		9 months, dry, at room temperature in original packing

\*MPA: Material testing laboratory for building industry, Hannover; ift: ift Rosenheim; BBS: BBS Institut, Wolfenbüttel

# Joint Tape 3 in 1 **ECO**

- Multi-functional tape for window connection joints according to the classic concept „interior tighter than exterior“
- Two-coloured: grey-inside / black-outside
- Air-tight and driving rain tightness
- Can be installed in any weather conditions
- Time and cost saving
- No edge tearing when components move
- Complies with EnEV and DIN 18355 for the German Construction Contract Procedures for carpentry
- General approval for construction



Theo Förch  
GmbH & Co KG  
74196 Neuenstadt

Herstellerwerk:H

P - NDS04 - 726

MPA Bau  
Hannover

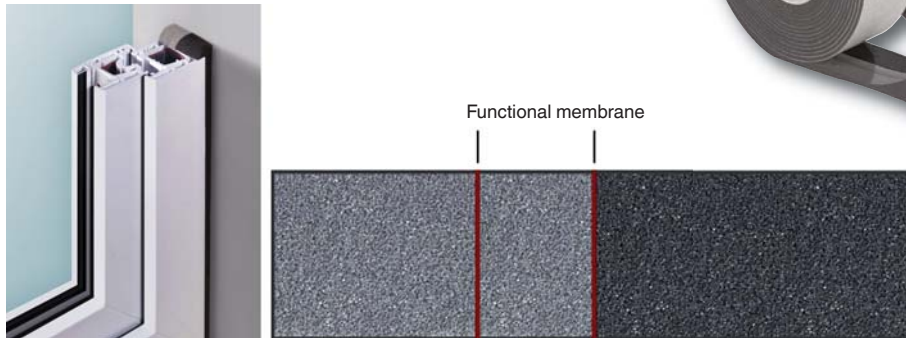

## Technical Data

Art. No.	Tape width in mm	Wind. constr. depth in mm	Joint width in mm
8807 56 6 15	56	60	6-15
8807 56 10 20	56	60	10-20
8807 64 6 15	64	70	6-15
8807 64 10 20	64	70	10-20
8807 64 15 30	64	70	15-30
8807 74 6 15	74	80	6-15
8807 74 10 20	74	80	10-20
8807 74 15 30	74	80	15-30
8807 84 6 15	84	90	6-15
8807 84 10 20	84	90	10-20

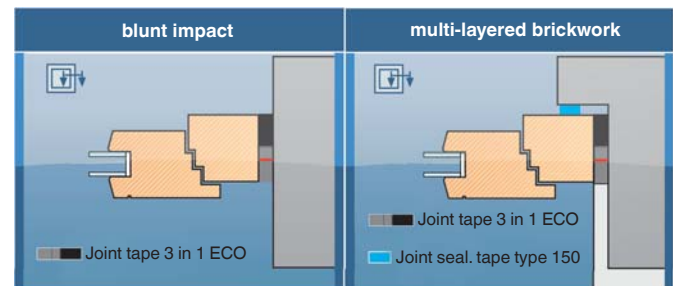

Article No.	Article Description	QTY
8807 56 6 15	RO(9.4)JOI.TA.3IN1ECO 56/ 6-15	5
8807 56 10 20	RO(7.0)JOI.TA.3IN1ECO 56/10-20	5
8807 64 6 15	RO(9.4)JOI.TA.3IN1ECO 64/ 6-15	4
8807 64 10 20	RO(7.0)JOI.TA.3IN1ECO 64/10-20	4
8807 64 15 30	RO(4.7)JOI.TA.3IN1ECO 64/15-30	4
8807 74 6 15	RO(9.4)JOI.TA.3IN1ECO 74/ 6-15	4
8807 74 10 20	RO(7.0)JOI.TA.3IN1ECO 74/10-20	4
8807 74 15 30	RO(4.7)JOI.TA.3IN1ECO 74/15-30	4
8807 84 6 15	RO(9.4)JOI.TA.3IN1ECO 84/ 6-15	3
8807 84 10 20	RO(7.0)JOI.TA.3IN1ECO 84/10-20	3

Colour:		grey-inside / black-outside, with functional membrane
Wear group:	DIN 18542:2009	BG-2/BG-R
Fire behaviour:	DIN 4102-1	B2; P-NDS04-726, MPA*
Joint permeability coefficient:	DIN EN 12114	$a_n \leq 0.1$ ; 095404. 1- Sz, MPA*
Driving rain tightness:	DIN EN 1027	$\geq 600$ Pa; 095404. 1- Sz, MPA*
Water vapour diffusion resistance:	DIN EN ISO 12572	Inside: 19.2; outside: 3.5; 095405. 1 - Sz, MPA* sd > 0.5 m (from 56 mm tape width)
Temperature resistance:		-30° to +80°C
Thermal conductivity:	DIN EN 12667	$\lambda \leq 0.0428$ W/m*K U-value = 0.58 W/(m²K) at 74 mm tape width
Joint sound insulation $R_{ST,W}$ :	ift SC-01/2:2002-09	unplastered: 57 dB
Compatibility with standard material:		yes
Processing temperature:		+5° to +30°C. Pre-cool the tape at +20°C, pre-heat at low temperatures, if necessary.
Shelf life:		9 months, dry, at room temperature in original packing

\*MPA: Material testing laboratory for building industry, Hannover; ift: ift Rosenheim

# Joint Sealing Tape Type 150, Type 80, Type 70

- Joint sealing tape made from polyurethan soft foam with acrylate-dispersion-impregnation
- Permeable
- Driving rainproof
- Can be painted and varnished
- Free from chlorinated compounds, formaldehyde, cadium and CFC
- Pre-compressed and on-sided self-adhesive
- UV-, water and weather resistant (applies to type 150 and type 80)
- Sound and heat insulating
- Type 150 and type 80 comply with the stress group BG 2 or BG 1 as per DIN 18542 and hence comply with the requirements from > guideline for fitting RAL windows and >doors e.V. > as well as the energy saving regulation



## Application examples:

- Sealing between brickwork and window frames, door joints, outside window sills and in-roof frames for roof windows as well as sealing of joints between concrete prefabricated parts
- Can be used for connection and expansion joints for facade-, prefab and wood house construction as well as to seal profiles during dry finishing

## Type 150:

- Meets highest expectations
- For direct joint weathering, strong driving rains and high condensation effects, long-term effect of humidity and normal wind density
- Suitable for increased requirements on temperature resistance and special weathering stresses for buildings with a height of up to 100 m
- Highly sound insulating and also suitable for heating insulation systems

## Type 80:

- A tape, which meets specific and high requirements, even for upgraded insulation systems
- For minor driving rains and high condensation effects, long-term effect of humidity and normal wind density
- Suitable for almost any use both in- and outdoor for buildings up to 20 m height

## Type 70:

- A joint sealing tape with excellent quality features in a B2 quality, which is suitable for requirements which do not have to comply to DIN 18542 or WSV
- Mainly suitable as backfilling tape or as additional insulating level for indoor use, e.g. to seal partitioning walls or wall breakthroughs
- Also used for backfilling of connection joints

Article No.	Article Description	QTY
8800 70 10 2	MTR.JOINT TAPE 70K 10X2/10	378
8800 70 15 3	MTR.JOINT TAPE 70K 15X3/15	204
8800 70 15 4	MTR.JOINT TAPE 70K 15X4/20	162
8800 70 15 6	MTR.JOINT TAPE 70K 15X6/30	114
8800 70 20 2	MTR.JOINT TAPE 70K 20X2/10	198
8800 70 20 4	MTR.JOINT TAPE 70K 20X4/20	126
8800 70 20 6	MTR.JOINT TAPE 70K 20X6/30	84
8800 70 20 8	MTR.JOINT TAPE 70K 20X8/40	65
8800 80 8 2	MTR.JOINT TAPE 80K 8X2/10	444
8800 80 10 2	MTR.JOINT TAPE 80K 10X2/10	360
8800 80 10 4	MTR.JOINT TAPE 80K 10X4/20	225
8800 80 15 3	MTR.JOINT TAPE 80K 15X3/15	200
8800 80 15 4	MTR.JOINT TAPE 80K 15X4/20	150
8800 80 15 6	MTR.JOINT TAPE 80K 15X6/30	100
8800 80 15 8	MTR.JOINT TAPE 80K 15X8/40	86
8800 80 20 2	MTR.JOINT TAPE 80K 20X2/10	180
8800 80 20 4	MTR.JOINT TAPE 80K 20X4/20	113
8800 80 20 6	MTR.JOINT TAPE 80K 20X6/30	75
8800 80 20 8	MTR.JOINT TAPE 80K 20X8/40	65
8800 80 25 10	MTR.JOINT TAPE 80K 25X10/50	36
8800 80 30 6	MTR.JOINT TAPE 80K 30X6/30	50
8800 80 30 12	MTR.JOINT TAPE 80K 30X12/60	50
8800 150 10 2	MTR.JOINT TAPE 150K 10X2/10	360
8800 150 15 3	MTR.JOINT TAPE 150K 15X3/15	200
8800 150 15 4	MTR.JOINT TAPE 150K 15X4/20	150
8800 150 15 6	MTR.JOINT TAPE 150K 15X6/30	100
8800 150 15 8	MTR.JOINT TAPE 150K 15X8/40	86
8800 150 20 2	MTR.JOINT TAPE 150K 20X2/10	180
8800 150 20 4	MTR.JOINT TAPE 150K 20X4/20	113
8800 150 20 6	MTR.JOINT TAPE 150K 20X6/30	75
8800 150 20 8	MTR.JOINT TAPE 150K 20X8/40	65
8800 150 25 10	MTR.JOINT TAPE 150K 25X10/50	36
8800 150 30 6	MTR.JOINT TAPE 150K 30X6/30	50
8800 150 30 12	MTR.JOINT TAPE 150K 30X12/60	50



## Technical Data

Article No.	Type	Pre-compressed bandwidth (width x thickness in mm)	For joint depth in mm	For joint depth driving rain proof as per DIN 18542 in mm
8800 70 10 2	70	10 x 2	10	2
8800 70 15 3	70	15 x 3	15	3
8800 70 15 4	70	15 x 4	15	3 - 5
8800 70 15 6	70	15 x 6	15	5 - 7
8800 70 20 2	70	20 x 2	20	2
8800 70 20 4	70	20 x 4	20	3 - 5
8800 70 20 6	70	20 x 6	20	5 - 7
8800 70 20 8	70	20 x 8	20	7 - 10
8800 80 8 2	80	8 x 2	8	2
8800 80 10 2	80	10 x 2	10	2
8800 80 10 4	80	10 x 4	10	3 - 7
8800 80 15 3	80	15 x 3	15	3
8800 80 15 4	80	15 x 4	15	3 - 7
8800 80 15 6	80	15 x 6	15	5 - 9
8800 80 15 8	80	15 x 8	15	7 - 12
8800 80 20 2	80	20 x 2	20	2
8800 80 20 4	80	20 x 4	20	3 - 7
8800 80 20 6	80	20 x 6	20	5 - 9
8800 80 20 8	80	20 x 8	20	7 - 12
8800 80 25 10	80	25 x 10	25	8 - 15
8800 80 30 6	80	30 x 6	30	5 - 9
8800 80 30 12	80	30 x 12	30	10 - 18
8800 150 10 2	150	10 x 2	10	2
8800 150 15 3	150	15 x 3	15	3
8800 150 15 4	150	15 x 4	15	3 - 7
8800 150 15 6	150	15 x 6	15	5 - 9
8800 150 15 8	150	15 x 8	15	7 - 12
8800 150 20 2	150	20 x 2	20	2

\* If the joint edges do not run completely parallel, then choose the band width according the widest joint measurement. The recommended band widths may neither be exceeded or undercut to ensure problemfree functioning. Self-adhesive band width corresponds to minimum joint depth. Compression grades up to **25%** guarantee airtight finish as per DIN 18542.

Type:	70	80	150
Joint permeability coefficient (a) (Joint permeability):	-	on $\leq 1,0 \text{ m}^3/\text{h}\cdot\text{m}$	on $\leq 1,0 \text{ m}^3/\text{h}\cdot\text{m}$
Driving rain tightness of joints:	$\geq 300 \text{ Pa}$	$\leq 600 \text{ Pa}$	$\geq 600 \text{ Pa}$
Driving rain tightness of cross joint:	-	-	$\geq 600 \text{ Pa}$
Fire behavior (DIN 4102-1):	B2	-	B1
Temperature resistance:	-30°C to +80°C	-30°C to +80°C	-30°C to +80°C
Recommended for building height:	up to 8 m	up to 20 m	up to 100 m
Shelf life:	18 months	18 months	18 months
Test certificates:	general building inspection authority approval on B2	general building inspection authority on B2, test report on BG2 as per EDIN 18542	general building inspection authority approval on B1, test report on BG1 as per EDIN 18542: 2008

# Sealing Web EPDM-Plus and EPDM-Basic

- For secure and durable sealing of outdoor connection joints, e.g. for floor level windows, balcony and terrace doors, entrance door thresholds as well as for facades
- Watertight and permeable
- High flexibility and tear resistance, ideal absorption of structural movement
- Weather and UV resistant

## Processing instructions:

- Adhesive surfaces have to be clean, dry, stable, dust- and grease-free
- Cut the web to the required length and apply adhesive on surface depending on use and type, then press on EPDM-web
- Ensure tensionfree fit
- If necessary fit with press-down battons, strips or similar
- Not suitable for sealants, against pressing water as well as for surfaces made from Teflon, PE and PP

## Technical Data

<b>Basis:</b>	EPDM-rubber
<b>Colour:</b>	black
<b>Material thickness:</b>	0.8 mm
<b>Max. elongation of break:</b>	300 %
<b>Tensile strength:</b>	8 N/mm <sup>2</sup>
<b>Steam equivalents</b>	
<b>Air layer thickness (Sd-value):</b>	4.7 m
<b>Steam permeability resistance value:</b>	μ approx. 5882
<b>Processing temperature:</b>	+5° to +35°C
<b>Temperature resistant:</b>	-30°C to +100°C

Article No.	Article Description	QTY
8804 11 150	MTR<20>SEAL.TAPE EPDM PLUS 150	80
8804 11 200	MTR<20>SEAL.TAPE EPDM PLUS 200	80
8804 11 250	MTR<20>SEAL.TAPE EPDM PLUS 250	40
8804 11 300	MTR<20>SEAL.TAPE EPDM PLUS 300	40
8804 11 400	MTR<20>SEAL.TAPE EPDM PLUS 400	40
8804 11 500	MTR<20>SEAL.TAPE EPDM PLUS 500	40
8804 12 150	MTR<25>SEAL.TAPE EPDM BASIC150	175
8804 12 200	MTR<25>SEAL.TAPE EPDM BASIC200	125
8804 12 250	MTR<25>SEAL.TAPE EPDM BASIC250	100
8804 12 300	MTR<25>SEAL.TAPE EPDM BASIC300	50
8804 12 400	MTR<25>SEAL.TAPE EPDM BASIC400	50
8804 12 500	MTR<25>SEAL.TAPE EPDM BASIC500	50

## Adhesive EPDM

- For adhesion of Foerch EPDM-sealing webs to almost all standard surfaces such as concrete, brick, plaster, natural stone, aluminium, steel, zinc, copper, wood, tiles, styrodur etc.

- Elastic
- Stable
- Reduced level of solvent

## Processing instructions:

- Adhesive surfaces have to be clean, dry, stable, dust- and grease-free
- Apply the EPDM-adhesive on the surfaces using putty knife
- Adhere the EPDM-web and roll on carefully (using a pressure roll)
- not suitable for sealants, against pressing water as well as for surfaces made from Teflon, PE and PP
- We recommend to carry out some tests on bitumen webs or bitument paint surfaces due to the different systems available and to also secure the web mechanically

Article No.	Article Description	QTY
6880 1 600	B(600ML)SEALING GLUE EPDM	12



Type Basic:

sealing tape

Type Plus:

sealing tape

butyl



## Technical Data

<b>Build. mat. class acc. to DIN 4102-1:</b>	B2
<b>Basis:</b>	special polymer
<b>Colour:</b>	black
<b>Skin formation time:</b>	60 mins
<b>Hardening:</b>	about 2 mm/24 hrs
<b>Processing temperature:</b>	+5 to +35°C
<b>Temperature resistant:</b>	-30 to +80°C
<b>Shelf life:</b>	12 months

# Window Refurbishment Rail



- For air-tight sealing of the inner window connection joint
- Tested as per the current guidelines by ift Rosenheim MO-01/1
- No change to structural surfaces - no plastering - no dirt
- Ideal absorption of structural movements
- No drying time
- Ideal for refurbishment, but also suitable for new buildings
- Excellent adhesion on the following surfaces:
  - Wood, unplanned
  - Wood, planed
  - Plaster rendering
  - Lime-cement-rendering
  - Diamond mineral rendering up to 2mm
  - Woodchip wallpaper

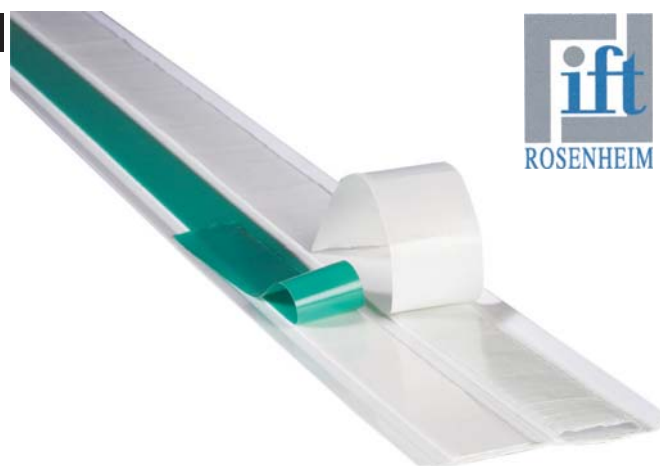

- Consisting of two solid hard-PVC-brackets with sealing lips connected by a flexible joint
- Complete with foam-self-adhesive strip (facing the window frame) and a special flexible tube sealant (facing the structure) - this allows excellent absorption of structural movement



Article No.	Article Description	QTY
8805 30 30 50	MTR<50>F-RENOV.STRIP.30/30	50

# Glazing Blocks AIR

- Due to their labyrinth ventilation system, they not only allow longitudinal ventilation but also lateral ventilation
- Grooved surface
  - Ideal adhesion due to the gripping of the glazing block onto the unpolished glass edge
  - No subsequent moving or slipping possible
- Glazing blocks AIR are made from plastic (polypropylene)
  - Antifungal unlike wooden blocks
  - Compatible with all edge compound materials
- Glazing blocks AIR comply with HADAMER guidelines and have a minimum installation surface of 700 mm<sup>2</sup>
- Block length: 100 mm

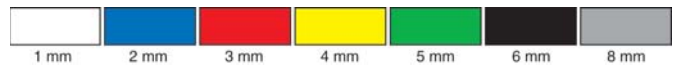

Article No.	Article Description	QTY
8331 20 1	GLAZING BLOCK AIR WHITE 20X1	1000
8331 20 2	GLAZING BLOCK AIR BLUE 20X2	1000
8331 20 3	GLAZING BLOCK AIR RED 20X3	1000
8331 20 4	GLAZING BLOCK AIR YELLOW 20X4	1000
8331 20 5	GLAZING BLOCK AIR GREEN 20X5	1000
8331 20 6	GLAZING BLOCK AIR BLACK 20X6	1000
8331 22 1	GLAZING BLOCK AIR WHITE 22X1	1000
8331 22 2	GLAZING BLOCK AIR BLUE 22X2	1000
8331 22 3	GLAZING BLOCK AIR RED 22X3	1000
8331 22 4	GLAZING BLOCK AIR YELLOW 22X4	1000
8331 22 5	GLAZING BLOCK AIR GREEN 22X5	1000
8331 22 6	GLAZING BLOCK AIR BLACK 22X6	1000
8331 24 1	GLAZING BLOCK AIR WHITE 24X1	1000
8331 24 2	GLAZING BLOCK AIR BLUE 24X2	1000
8331 24 3	GLAZING BLOCK AIR RED 24X3	1000
8331 24 4	GLAZING BLOCK AIR YELLOW 24X4	1000
8331 24 5	GLAZING BLOCK AIR GREEN 24X5	1000
8331 24 6	GLAZING BLOCK AIR BLACK 24X6	1000
8331 26 1	GLAZING BLOCK AIR WHITE 26X1	1000
8331 26 2	GLAZING BLOCK AIR BLUE 26X2	1000
8331 26 3	GLAZING BLOCK AIR RED 26X3	1000
8331 26 4	GLAZING BLOCK AIR YELLOW 26X4	1000
8331 26 5	GLAZING BLOCK AIR GREEN 26X5	1000
8331 26 6	GLAZING BLOCK AIR BLACK 26X6	500
8331 26 8	GLAZING BLOCK AIR GREEN 26X8	500
8331 28 1	GLAZING BLOCK AIR WHITE 28X1	1000
8331 28 2	GLAZING BLOCK AIR BLUE 28X2	1000
8331 28 3	GLAZING BLOCK AIR RED 28X3	1000
8331 28 4	GLAZING BLOCK AIR YELLOW 28X4	1000
8331 28 5	GLAZING BLOCK AIR GREEN 28X5	500
8331 28 6	GLAZING BLOCK AIR BLACK 28X6	500
8331 28 8	GLAZING BLOCK AIR GREY 28X8	500

Article No.	Article Description	QTY
8331 30 1	GLAZING BLOCK AIR WHITE 30X1	1000
8331 30 2	GLAZING BLOCK AIR BLUE 30X2	1000
8331 30 3	GLAZING BLOCK AIR RED 30X3	1000
8331 30 4	GLAZING BLOCK AIR YELLOW 30X4	1000
8331 30 5	GLAZING BLOCK AIR GREEN 30X5	500
8331 30 6	GLAZING BLOCK AIR BLACK 30X6	500
8331 32 1	GLAZING BLOCK AIR WHITE 32X1	1000
8331 32 2	GLAZING BLOCK AIR BLUE 32X2	1000
8331 32 3	GLAZING BLOCK AIR ROT 32X3	1000
8331 32 4	GLAZING BLOCK AIR YELLOW 32X4	1000
8331 32 5	GLAZING BLOCK AIR GREEN 32X5	500
8331 32 6	GLAZING BLOCK AIR BLACK 32X6	500
8331 34 1	GLAZING BLOCK AIR WHITE 34X1	1000
8331 34 2	GLAZING BLOCK AIR BLUE 34X2	1000
8331 34 3	GLAZING BLOCK AIR RED 34X3	500
8331 34 4	GLAZING BLOCK AIR YELLOW 34X4	500
8331 34 5	GLAZING BLOCK AIR GREEN 34X5	500
8331 34 6	GLAZING BLOCK AIR BLACK 34X6	500
8331 36 1	GLAZING BLOCK AIR WHITE 36X1	1000
8331 36 2	GLAZING BLOCK AIR BLUE 36X2	1000
8331 36 3	GLAZING BLOCK AIR RED 36X3	1000
8331 36 4	GLAZING BLOCK AIR YELLOW 36X4	1000
8331 36 5	GLAZING BLOCK AIR GREEN 36X5	500
8331 36 6	GLAZING BLOCK AIR BLACK 36X6	500
8331 40 1	GLAZING BLOCK AIR WHITE 40X1	1000
8331 40 2	GLAZING BLOCK AIR BLUE 40X2	1000
8331 40 3	GLAZING BLOCK AIR RED 40X3	1000
8331 40 4	GLAZING BLOCK AIR YELLOW 40X4	500
8331 40 5	GLAZING BLOCK AIR GREEN 40X5	500
8331 40 6	GLAZING BLOCK AIR BLACK 40X6	500
8331 40 8	GLAZING BLOCK AIR GREY 40X8	500