

MAIN BUILDING

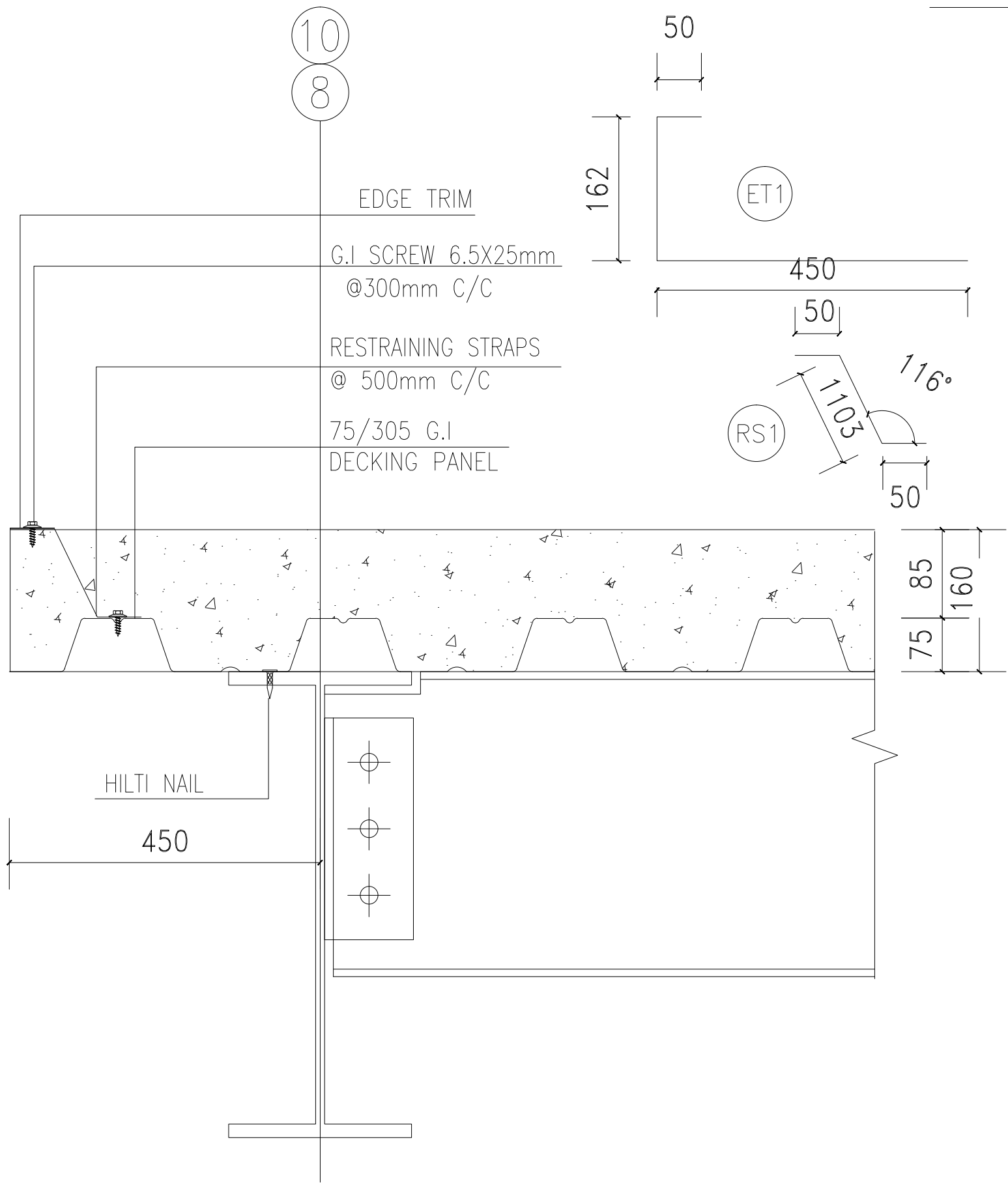

NOTE : 1).NOTCHING & SMALL CUT OUT OF DECKING WOULD BE CUT AT SITE.
2). ALL GIVEN MEASUREMENTS ARE SUBJECT TO ACCEPTED TOLERANCE
3). CLADDING MATERIAL SPECIFICATIONS ARE AS FOLLOWS:
A) DECKING PANELS:
75/305 PROFILE 0.8mm THK. G.I MILL FINISH
B) RESTRAINING STRAP & EDGE TRIM:
1.2mm THK. G.I MILL FINISH

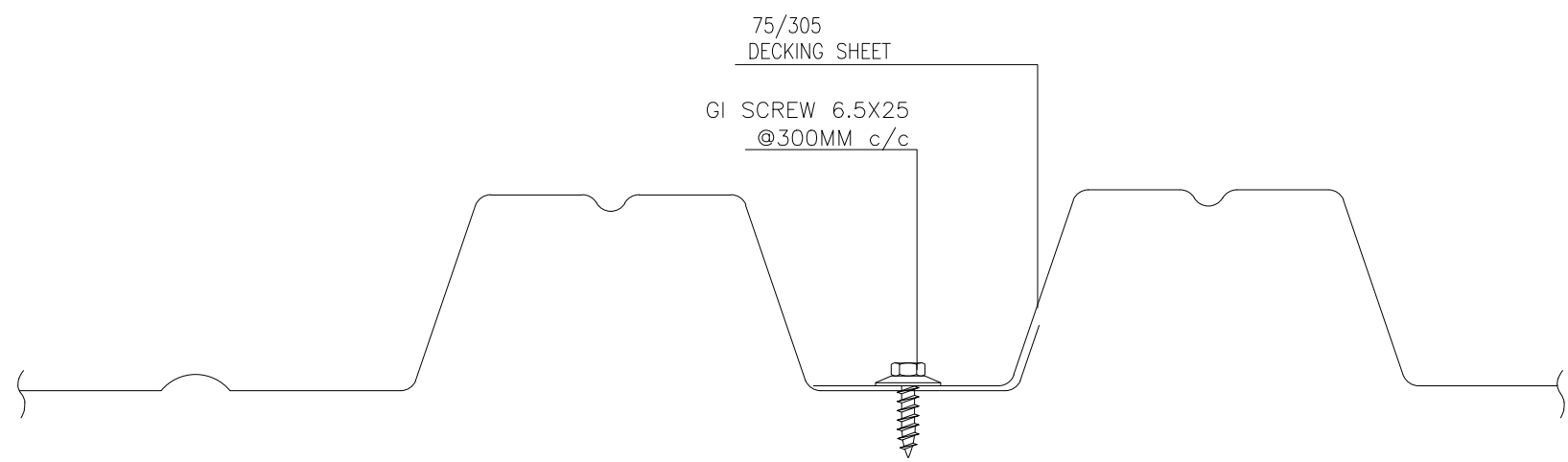

DETAIL AT SIDE LAP

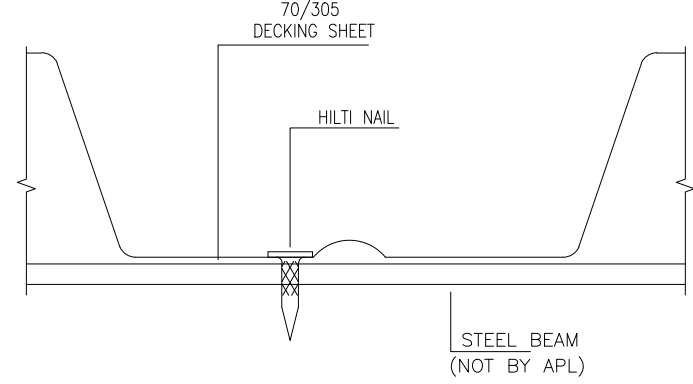

FIXING DETAIL OF 75/305 DECKING PROFILE

HILTI NAIL 19mm 2 Nos. PER SHEET OF WIDTH ON EVERY INTERMEDIATE BEAMS AND 3 Nos. PER SHEET OF WIDTH AT SHEET ENDS.

75/305 Profiled Steel Sheeting (GI)

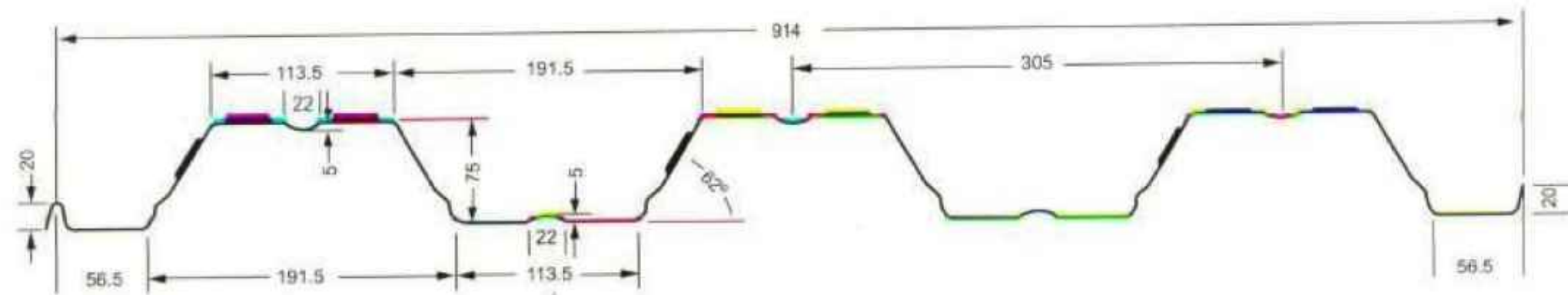

ACCOMMODATION

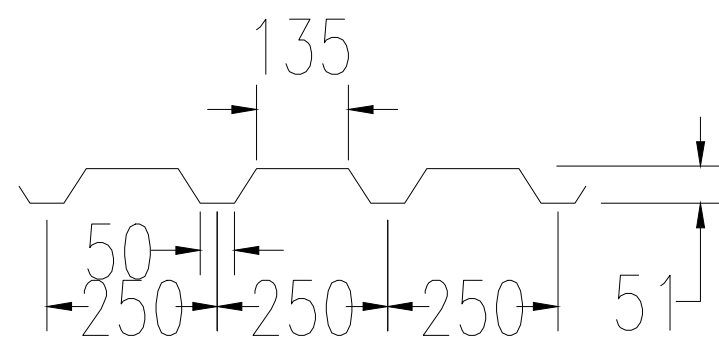
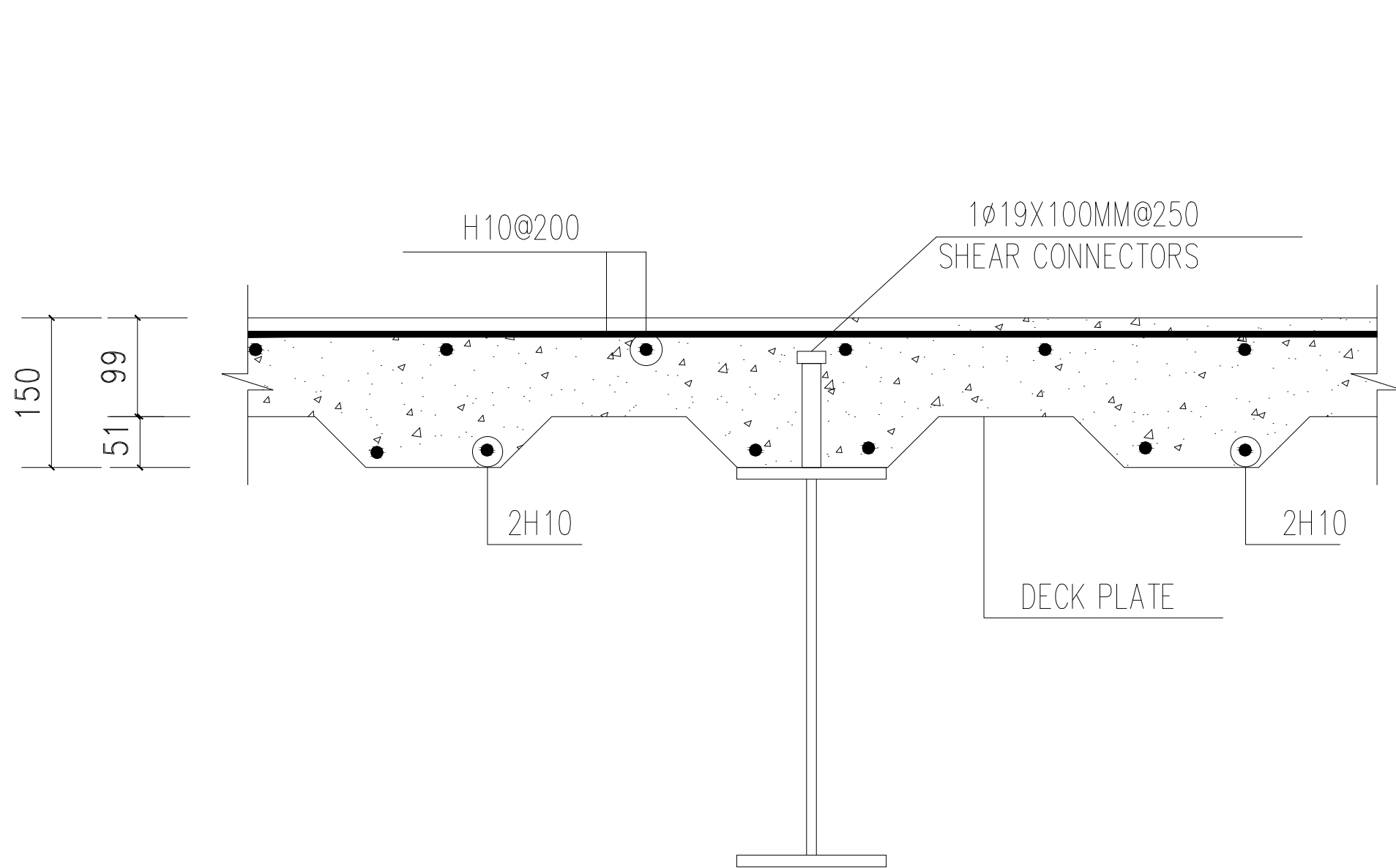

DECK PLATE
t=0.8mm
fy=275N/mm ^2

NOTES:

- THE REQUIREMENT TO THE PROFILED STEEL SHEET:
1. YIELD STRENGTH: Q275
 2. THICKNESS t=0.8mm
 3. GALVANIZATION THICKNESS: 275 G/M2 (DOUBLE SIDE TOTAL)
 4. UNMARKED BAR DIAMETER IS 10mm.