

Title: Quotation of Electric Motors.

We intend to purchase below items:

Sr. No.	Description	Model	Make	Qty (Nos.)
1	<u>Single Phase General Purpose Electrical Motor</u> Power:1.5 hp, RPM:1425, Voltage: 220 VAC± 5%, FLA: 6~10 Amps., Frame: 56 C (NEMA), IP 55, Frequency: 50 Hz, Efficiency: 73%, PF: 0.88, Ambient Temperature: 40°C, Ser. Factor: 1.15, Enclosure TEFC, Insulation Class B or F, Design Class L, Continuous Duty S1, Model required in C-Face Flange, Mounting Position= Vertical, Provision of one set of spare capacitors for each motor [Drawing attached at Page-2]	L3514-50	Baldor, USA	08
		Or Equivalent		
2	<u>Single Phase General Purpose Electrical Motor</u> Power: 3.0 hp, RPM: 1425, Voltage: 220 VAC ± 5%, FLA: 8~12 Amps., Frame: 184TC (NEMA), IP: 55, Frequency: 50 Hz, Efficiency: 84.5%, PF: 0.98, Ambient Temperature: 40°C, Ser. Factor: 1.15, Enclosure TEFC, Insulation Class F, Design Class L, Continuous Duty S1, Model required in C-Face Flange, Mounting Position = Vertical, Provision of one set of spare capacitors for each motor [Drawing attached at Page-3]	-	Baldor, USA	05
		Or Equivalent		
3	C-Face Flange Kit package to convert frame size 184T to 184TC	-	Baldor, USA	04
		Or Equivalent		

Kindly send us your best offer in accordance with the following General Conditions as stated below:

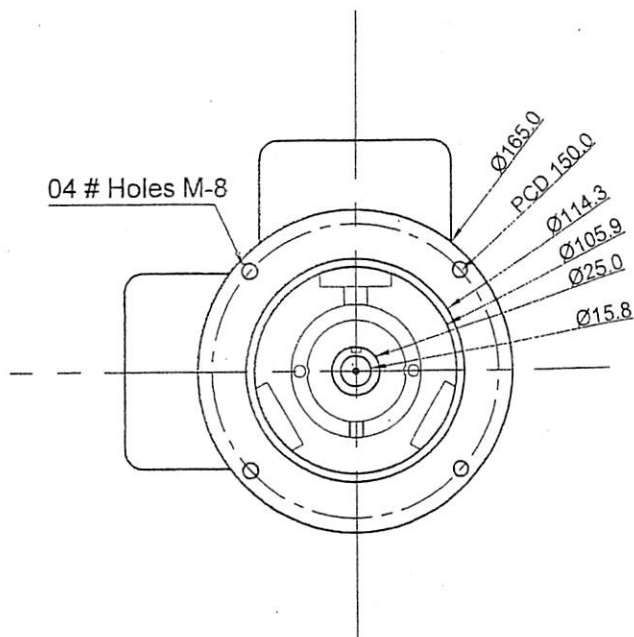

Front View

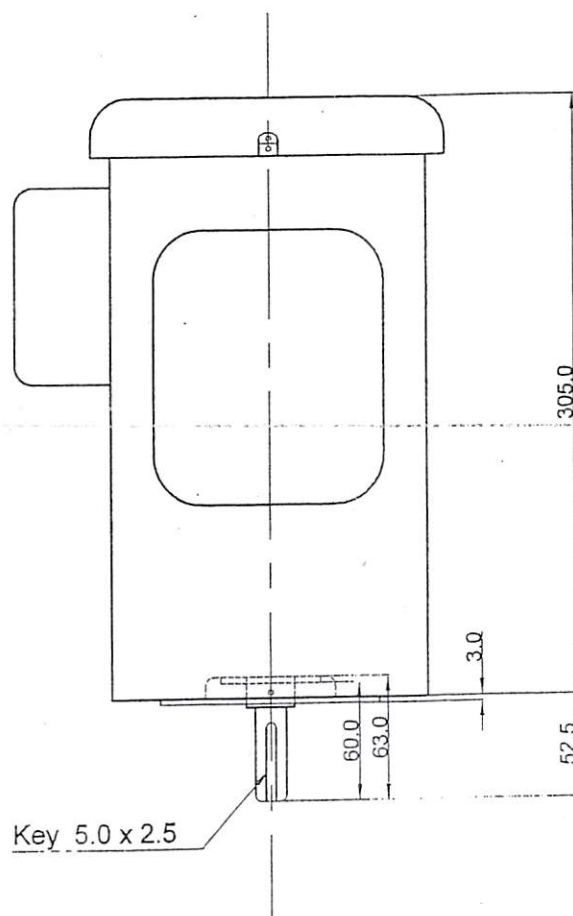

Top View

**MOTOR FOR DIAPHRAGM
METERING PUMP (100 GPH)**

RPM	1425
HP	1.5
Volt	220 ± 5%
FLA	6~10 Amp.
Hz	50
Insulation Class	B or F
Encl.	TEFC
Frame	56C
IP	55

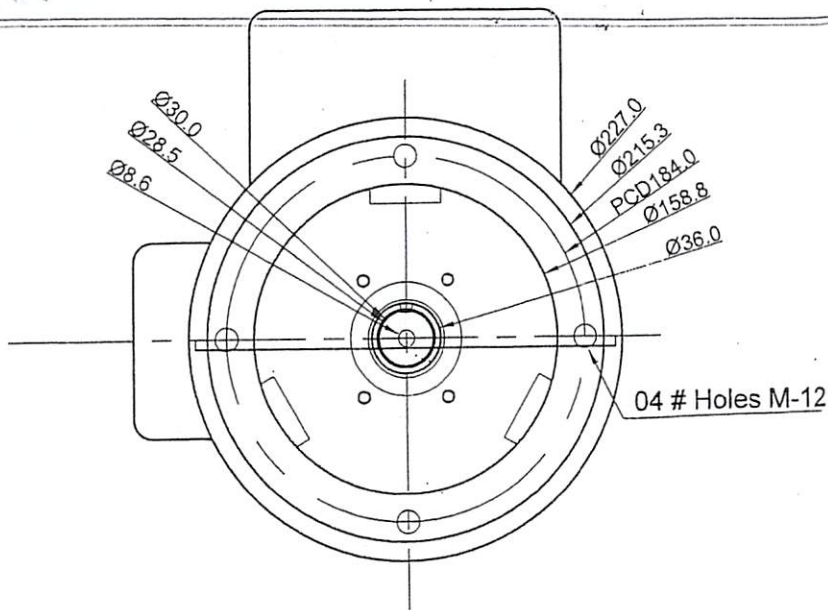

Front View

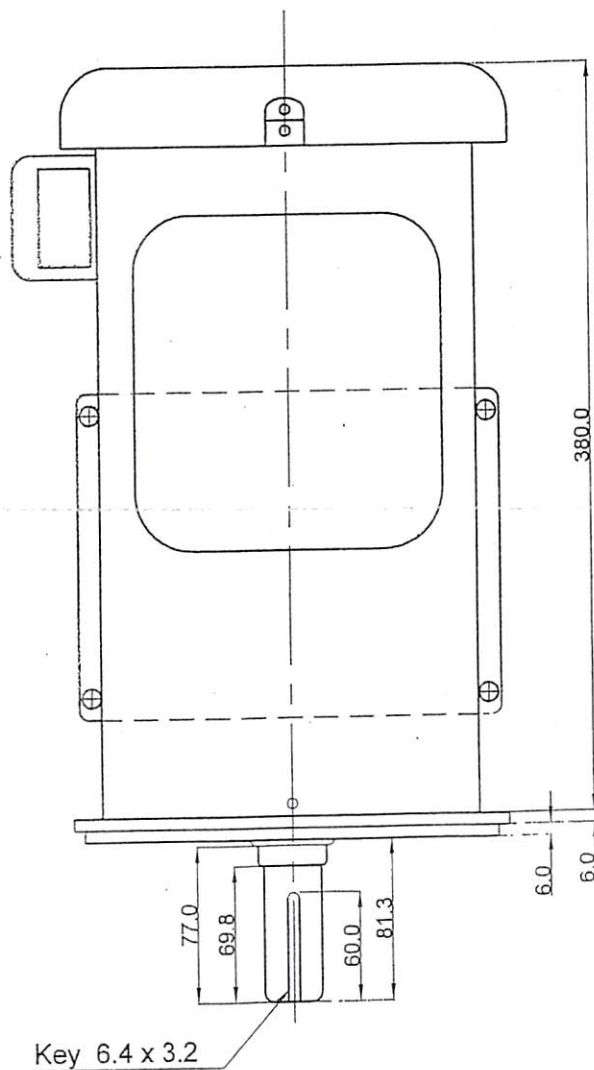

Top View

**C-FACE MOTOR FOR DIAPHRAGM
METERING PUMP (216 GPH)**

RPM	1425
HP	3
Volt	220 ± 5%
FLA	8~12 Amp.
Hz	50
Insulation Class	F
Encl.	TEFC
Frame	184 TC
IP	55

Note: All Dimensions are in mm