

26.504

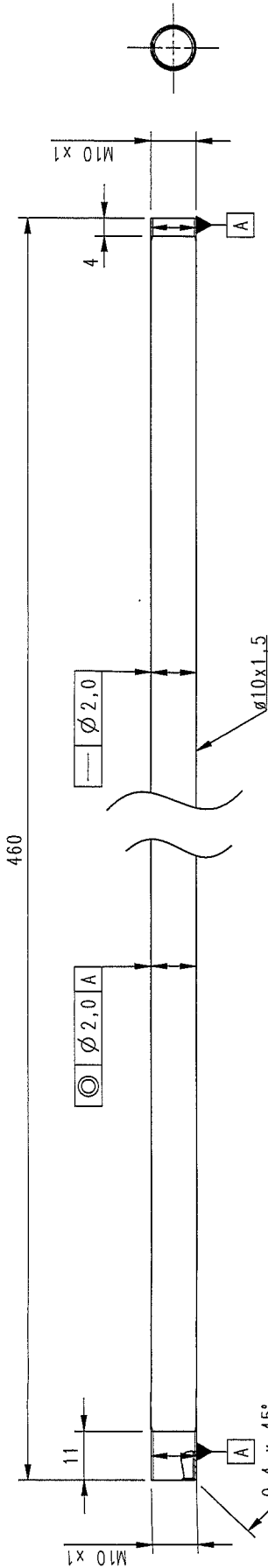

CAMFERED INSIDE/outside

NO DENTS MARKS OR SCRATCHES ON TUBE.

TEST WITH M10 GO/NO GO. HANDLE WITH CARE.

管子表面不要有刮痕
M10测试
小心轻放

No printed text on the tube

DATE OF CHANGE 12.04.2012		THE CHANGE INCLUDES Chamfer outside		is deleted, so now it is only inside. See *.		CHANGED BY KKJ,DK	
MATERIAL: teel E235+C, EN 10305-1 (DIN2391)				DATE: 19.08.2011		DRAWN BY alt.dk	
TOLERANCES Linear tolerances as indicated below. Thread tolerances according to ISO 965-1:1988 (6H/6g). Specific tolerances in drawing override general.				WEIGHT: -		SCALE 1:1	
over		0		30		1000	
up to		6		30		1000	
Di m.		±0.1		±0.3		±0.8	
±0.3		±0.5		±0.8		±1.0	
±0.8		±1.0		±1.5		±2.0	
±1.0		±1.5		±2.0		±3.0	
DRAWING NO. VER NO. 24059-D10, 03				SHEETS 1		DRAWING NO. VER NO. 24059-D10, 03	

MILLIMETERS

DO NOT SCALE THIS DRAWING

FIRST ANGLE PROJECTION

26505

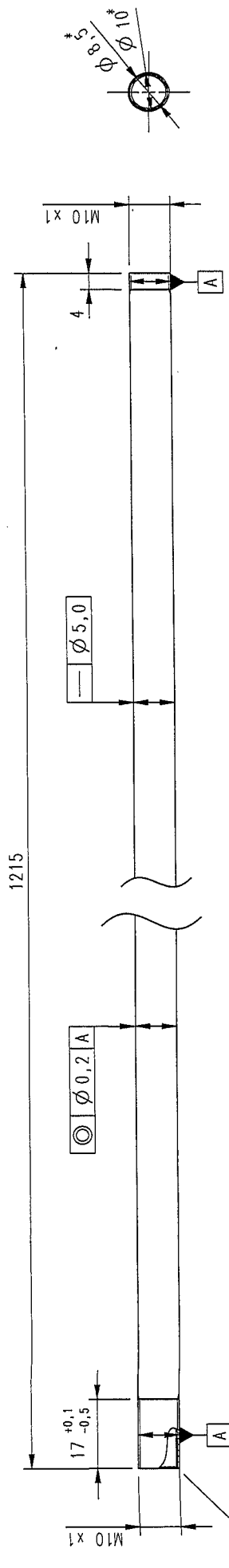

No marks or scratches on the tube
 No handling marks
 M10 x 1 Test with GO/NOGO ring
 Polished surface

No printed text on the tube

DATE OF CHANGE 19.12.2012		THE CHANGE INCLUDES Added dimension. See *.		CHANGED BY KKJ/DK	
DK-TITLE: Rør, AJ guivlampe. Tube for AJ floor.					
MATERIAL: Steel E235+C, EN 10305-1 (DIN2391)					
DATE: 19.08.2011					
DRAWN BY alt.dk					
SCALE 1:1					
WEIGHT: 0,207kg					
DRAWING NO. - VER. NO. 28709-D10, 04					
SHEETS 1					

VOSS
 INDUSTRY & MEDICAL
 DENMARK

MILLIMETERS²

DO NOT SCALE
 THIS DRAWING
 FIRST ANGLE
 PROJECTION

26546

26 546

Section A-A

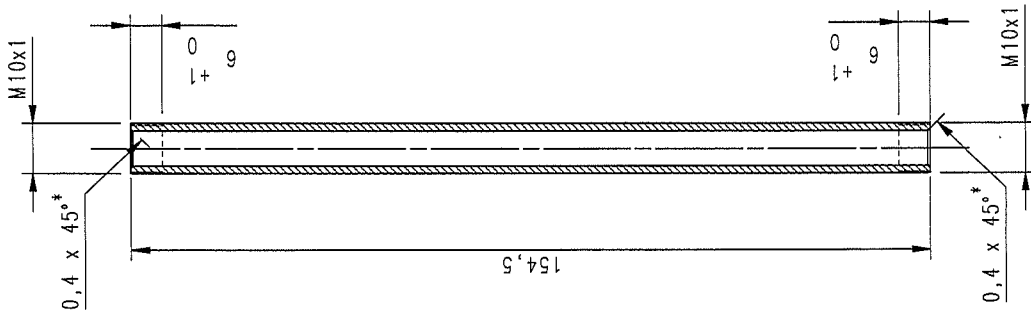

Section B-B

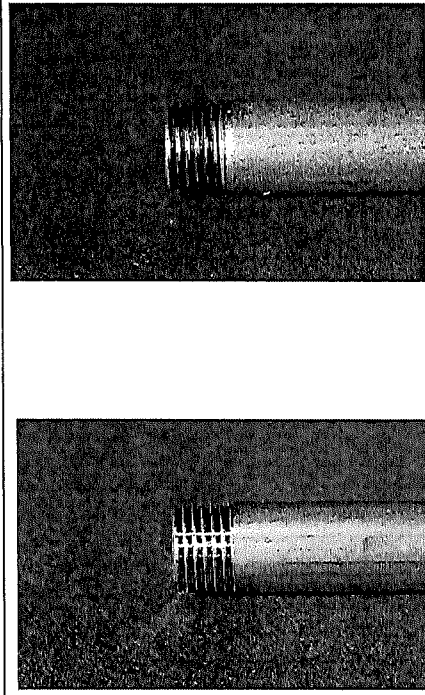
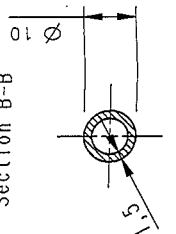

Machine cut



Made in screw die.

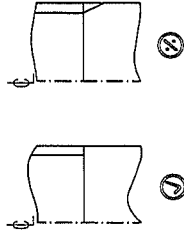

NO DENTS MARKS OR SCRATCHES ON TUBE.
TEST WITH M10 GO/NO GO.
HANDLE WITH CARE.

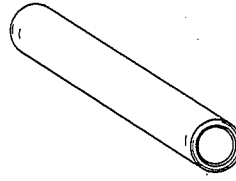

No printed text on tube!

DATE OF CHANGE 11.04.2012	THE CHANGE INCLUDES Changed pipe and chamfer. See #.	CHANGED BY KKJ,DK																																								
DK-TITLE: Rør, AJ Væg UK-TITLE: Tube, AJ Wall																																										
MATERIAL: Steel E235+C, EN 10305-1 (DIN2391)		DATE: 04.11.2011																																								
TOLERANCES Linear tolerances as indicated unless specified otherwise. Specific tolerances in drawing override general.		WEIGHT: DRAWN BY alt.dk																																								
<table border="1"> <tr> <td>over</td> <td>0</td> <td>5</td> <td>30</td> <td>100</td> <td>300</td> <td>1000</td> <td>10000</td> </tr> <tr> <td>up to</td> <td>6</td> <td>30</td> <td>100</td> <td>300</td> <td>1000</td> <td>10000</td> <td>100000</td> </tr> <tr> <td>Ø</td> <td>±0,1</td> <td>±0,2</td> <td>±0,3</td> <td>±0,5</td> <td>±0,8</td> <td>±1,0</td> <td>±1,2</td> </tr> <tr> <td>□</td> <td>±0,3</td> <td>±0,5</td> <td>±1,0</td> <td>±1,5</td> <td>±2,0</td> <td>±3,0</td> <td>±5,0</td> </tr> <tr> <td>∅</td> <td>±0,8</td> <td>±1,0</td> <td>±1,5</td> <td>±2,0</td> <td>±3,0</td> <td>±5,0</td> <td>±10,0</td> </tr> </table>		over	0	5	30	100	300	1000	10000	up to	6	30	100	300	1000	10000	100000	Ø	±0,1	±0,2	±0,3	±0,5	±0,8	±1,0	±1,2	□	±0,3	±0,5	±1,0	±1,5	±2,0	±3,0	±5,0	∅	±0,8	±1,0	±1,5	±2,0	±3,0	±5,0	±10,0	SCALE 1:1
over	0	5	30	100	300	1000	10000																																			
up to	6	30	100	300	1000	10000	100000																																			
Ø	±0,1	±0,2	±0,3	±0,5	±0,8	±1,0	±1,2																																			
□	±0,3	±0,5	±1,0	±1,5	±2,0	±3,0	±5,0																																			
∅	±0,8	±1,0	±1,5	±2,0	±3,0	±5,0	±10,0																																			
MILLIMETERS DO NOT SCALE THIS DRAWING FIRST ANGLE PROJECTION		SHEETS DRAWING NO., VER NO. 33090-D11, 03 1																																								

26449

GODKENDT
 DATO: 17.06.14. AF: M7.

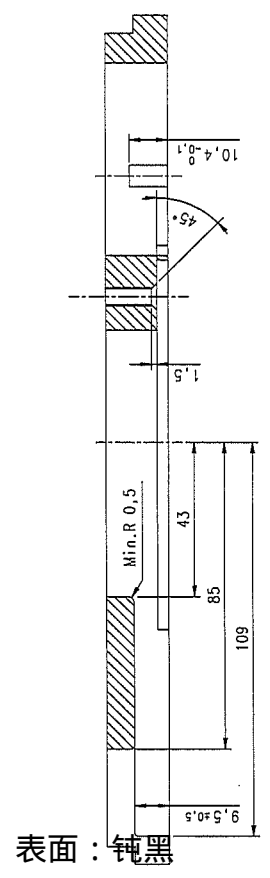
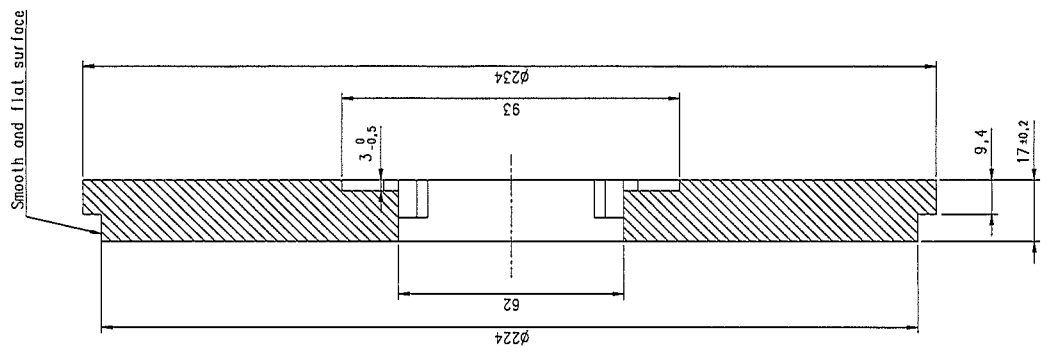
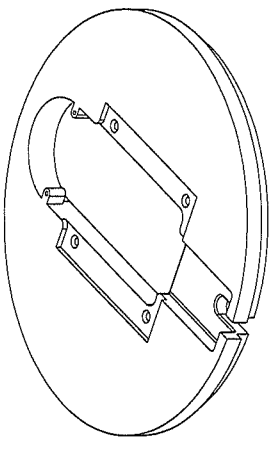
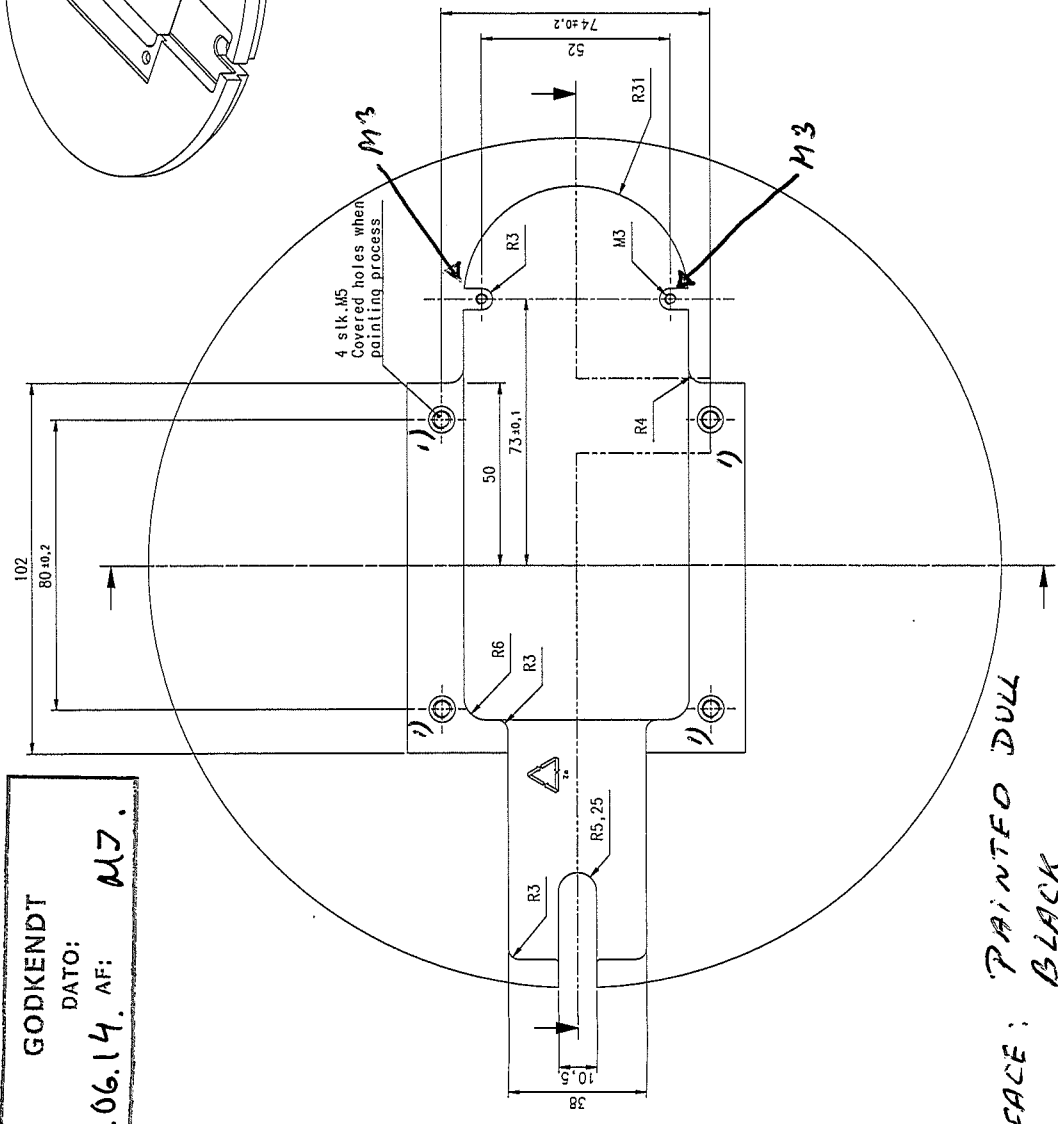

DATE OF CHANGE 10.06.2014	REASON FOR CHANGE Text changed from Danish to English	DESIGNED BY G.LL	DATE 19.01.2001
DRAWING TITLE Kontrolvæg 4 1/2-3 1/2 bord og 3 1/2-2 1/2 gulv Checkweigh 4 1/2-3 1/2 table and 3 1/2-2 1/2 floor		DRAWN BY JRS	SCALE 1:1
MATERIAL Zink ZP0410 EN12844		REGION 3.250kg	SHEETS 1
TOLERANCES		DRAWING NO. - VER. NO. 27092-020_07	
mm	mm	mm	mm
0.1	0.1	0.1	0.1
0.2	0.2	0.2	0.2
0.3	0.3	0.3	0.3
0.4	0.4	0.4	0.4
0.5	0.5	0.5	0.5
0.6	0.6	0.6	0.6
0.7	0.7	0.7	0.7
0.8	0.8	0.8	0.8
0.9	0.9	0.9	0.9
1.0	1.0	1.0	1.0
1.1	1.1	1.1	1.1
1.2	1.2	1.2	1.2
1.3	1.3	1.3	1.3
1.4	1.4	1.4	1.4
1.5	1.5	1.5	1.5

26449

Grade :	ZP5
Number:	ZP0410
Standard:	EN 12844 : 1998 Zinc and zinc alloys. Castings. Specifications
Classification:	Zinc alloy. Colour code white/black
Density	6.7 g/cm ³
Equivalent grades:	Go here

Chemical composition % of grade ZP5 (ZP0410)

Fe	Si	Ni	Al	Cu	Pb	Mg	Sn	Cd	-
max 0.05	max 0.03	max 0.02	3.7 - 4.3	0.7 - 1.2	max 0.005	0.025 - 0.06	max 0.002	max 0.005	Zn - remainder

Technological properties of grade ZP5

Melting temperature :	379 - 388 °C
-----------------------	--------------

Mechanical properties of grade ZP5 (ZP0410)

Rm - Tensile strength (MPa)	330
-----------------------------	-----

R _{p0.2} 0.2% proof strength (MPa)	250
---	-----

KV - Impact energy (J)	+20° 58
------------------------	------------

A - Min. elongation Lo = 50mm (%)	5
-----------------------------------	---

Brinell hardness (HB):	92
------------------------	----

Properties ZP5

Young modulus = 85 GPa;

Equivalent grades of grade ZP5 (ZP0410)

These comparison tables are only intended as an indication of the closest known equivalent grades.

USA	Germany DIN,WNr	France AFNOR	England BS	Italy UNI	Spain UNE	Sweden SS	Norway NS	Portugal NP
AG41A	2.2141.05 GD-ZnAl4Cu1 Z410	Z-A4U1	AlloyB	G-ZnAl4Cu1	ZnAl4Cu1	ZnAl4Cu1	ZnAl4Cu1	FZnAl4Cu1Mg

25296

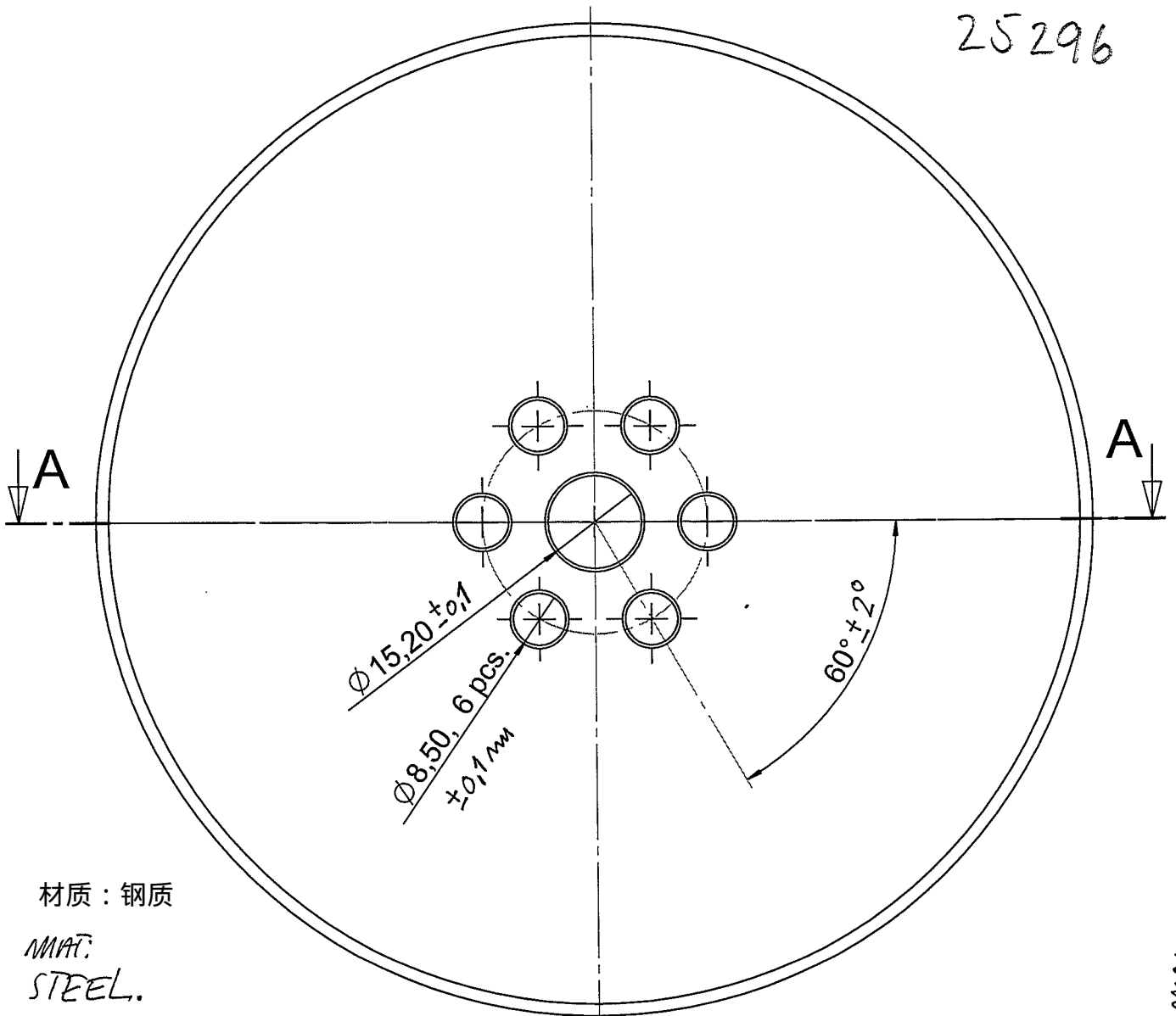

材质：钢质

MAT:
STEEL.

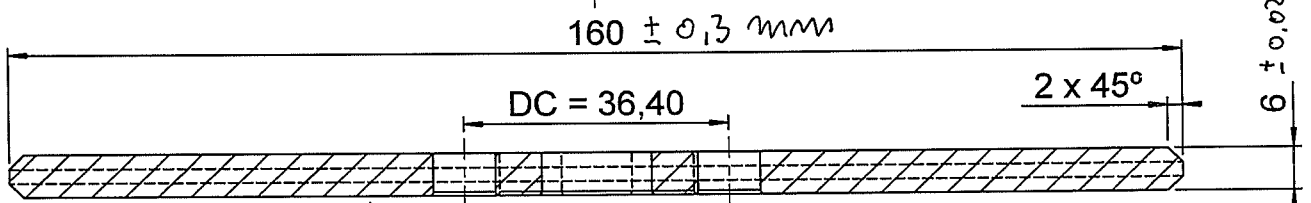

SECTION A-A

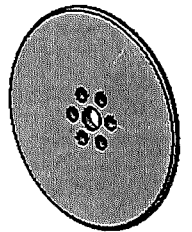
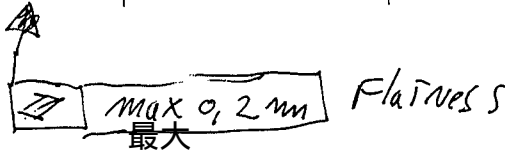

SURFACE TREATMENT: Electro galvanising min 25 µm Bright.

备选方案 镀锌
Alternative: Mechanical galvanization min. 54 µm.

材质

Material	Flat steel / 扁钢/平钢		Weight	Tolerances not specified acc. to	Drawn	14.05.98	ILA
Type 类型	S235JR/EN 10025:2-2004				Approv.	14.05.98	JLC
Colour		Dimension	g	EN 22768-mK	Modif.	23.06.10	ISB
Surface	Electro galv. Zn 25/A DIN/EN 12329	6 mm			Item number	520920	
Wire wheel	ø160/ø15.2 x 6 mm			Scale	1:1		
Version					02		
Status: Godkendt							

Last change: 23. juni 2010 13:26:53