

NOTE:
ALL POWER POINT AT BATHROOM SHALL HAVE ADDITIONAL SAFETY DEVICE "RCD" (RESIDUAL CURRENT DEVICE) TO BE FITTED ON A CABLE WIRE.

NOTE:
THIS DRAWING IS TO BE READ IN CONJUNCTION WITH DRAWINGS BY LIGHTING CONSULTANT
OPERATOR TO PROVIDE M&E / ID CONSULTANTS WITH PREFERRED ELECTRICAL LAYOUTS FOR APPROVAL / INTEGRATION BY M&E / ID PRIOR TO CONSTRUCTION ON SITE
SECURITY SYSTEM BY OTHERS.

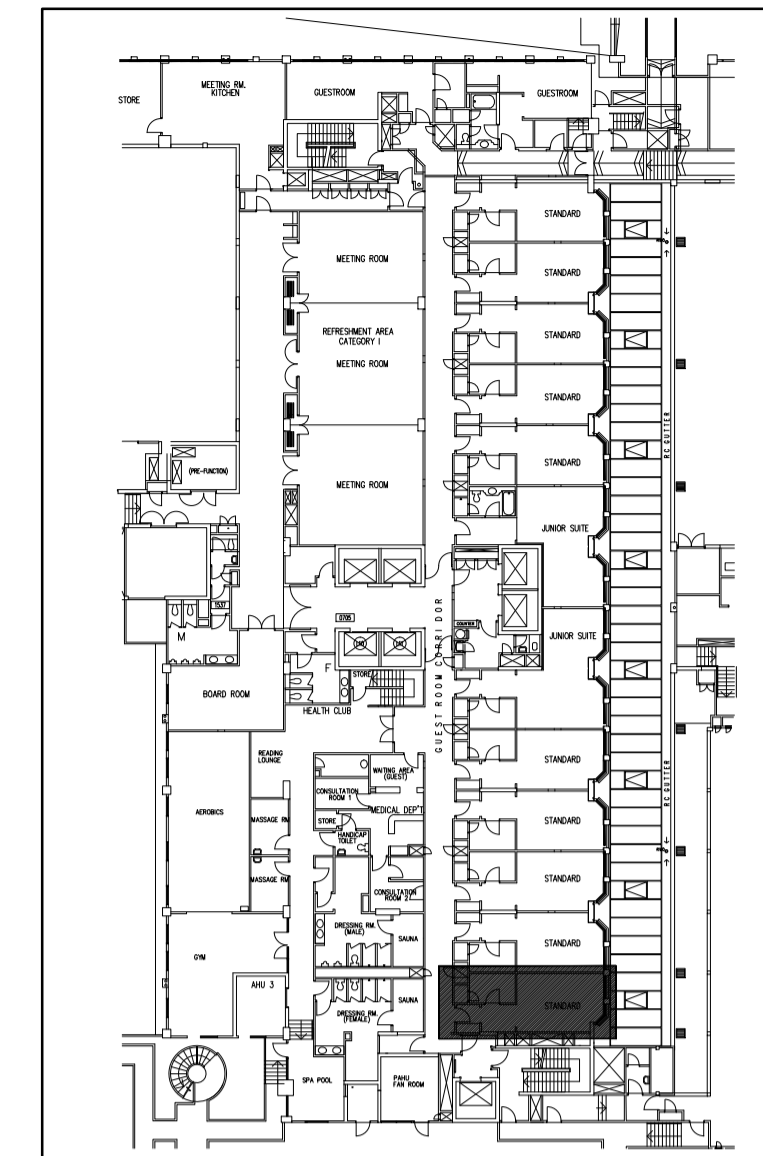
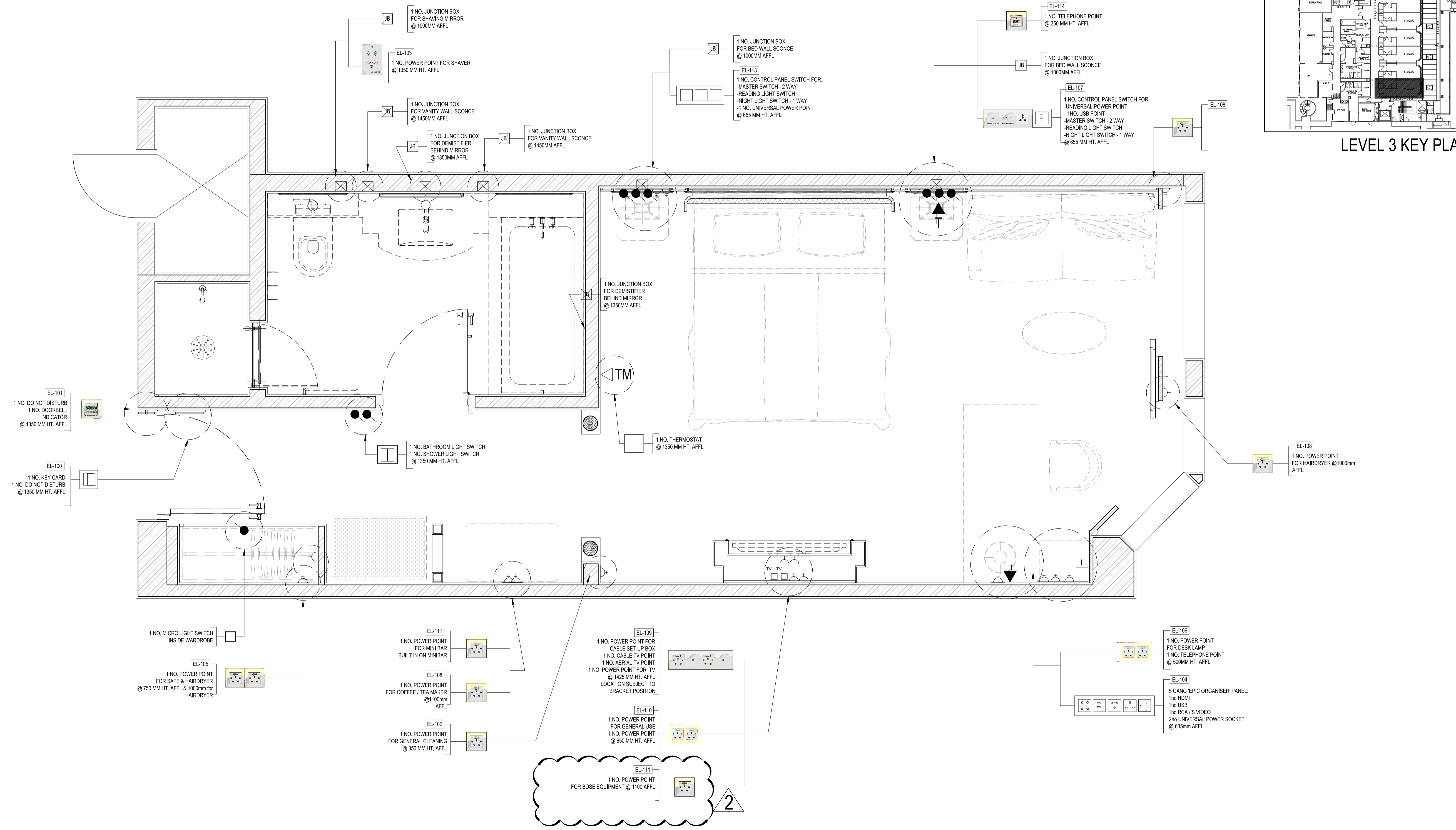

LEVEL 3 KEY PLAN

NOTES
(1) THIS DRAWING IS NOT TO BE SCALED - ONLY THE DIMENSIONS NOTED TO BE FOLLOWED.
(2) THE CONTRACTOR IS TO VERIFY ALL THE SITE DIMENSIONS AND NOTIFY FB EYE INTERNATIONAL PVT LTD OF ANY DISCREPANCIES FOUND BEFORE PROCEEDING WITH WORKS.
(3) ALL DIMENSIONS IN MILLIMETRES UNLESS OTHERWISE NOTED.
(4) THIS DESIGN IS COPYRIGHT AND MUST NOT BE REPRODUCED WITHOUT THE WRITTEN CONSENT OF FB EYE INTERNATIONAL PVT LTD.

REVISIONS
1. REVISED DRAWING JULY 24, 2013
2. REVISED DRAWING JULY 29, 2013



FB EYE INTERNATIONAL
(SINGAPORE • UK)
22A Mosque Street Singapore 052502
T +65 6325 9990 F +65 6226 2218 www.f-b-eye.com

PROJECT NAME AND ADDRESS:
INTERCONTINENTAL HOTEL PHASE 2
SINGAPORE

DRAWING TITLE
DELUXE KING GUESTROOM
ELECTRICAL PLAN

DRAWING TITLE
COORDINATION DRAWINGS CONTRACT DRAWINGS
TENDER DRAWINGS CONSTRUCTION DRAWINGS

PROJECT CODE: 1106

DRAWING NO.: MR-01-5.0

ALL DIMENSIONS IN MM

SCALE: 1:20 DRAWN BY: DPP

DATE: 17 JULY 2013 CHECKED BY: WFB